



Parents and Carers Meeting Proposed New Secondary School

Perth Grammar School
2 November 2015



PERTH &
KINROSS
COUNCIL

Securing the future... • Improving services • Enhancing
quality of life • Making the best use of public resources

Agenda

- **Welcome and Introductions**
- **Format of meeting**
- **The Proposal – A Reminder**
- **Presentations**
- **Questions**
- **Close and Thanks**

Panel / Introduction



Name

Title

Councillor Bob Band

Convener of Lifelong Learning Committee

Audrey May

Strategic Lead

Karen Robertson

Service Manager, Business Services

Thirza Pupillo

Headteacher, Pitlochry High School

Andy Cook

Contracts & Projects Manager

The Proposal – A Reminder



PKC recently undertook a Statutory Consultation for the following proposal:

- Establish a new secondary school on a preferred site at Bertha Park, Perth with effect from March 2018;
- Vary the existing admission arrangements to alter the catchment areas serving Perth Grammar School, Perth High School and Perth Academy to establish a catchment area for the proposed new secondary school, and establish temporary admission arrangements to accommodate the phased population of the new secondary school; and
- Vary the arrangements for the transfer of pupils from a primary school to a secondary school by altering the designated secondary school for the directly affected primary schools, and establish temporary transfer arrangements to accommodate the phased population of the new secondary school.

Why a new Secondary School?



- Perth and Kinross is one of the fastest growing areas of Scotland – projected 24% increase in population 2010-2035
- Perth City secondary schools will be near to capacity in 2021
- Review of our school estate identified new Perth secondary school as a priority
- Proposed new secondary school at Bertha Park reflects projected growth in population and resulting house building and infrastructure required to support this.

Statutory Consultation Process



- **Statutory Consultation closed on 19 November 2014**
- **Approx. 8900 Consultee Letters Issued**
- **23 Consultee Responses Received**
- **8 Minuted Public Meetings Between 22 September and 2 October 2014**
- **Education Scotland Report Received**
- **Consideration of Consultation Report (May 2015)**
- **Rephasing of Project agreed by Lifelong Learning Committee (August 2015)**
- **Final Decision by Lifelong Learning Committee (November 2015)**

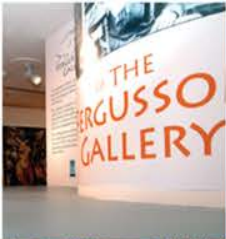

What did Parents tell us?

Common themes were:

- Two Transitions in one Academic Year
- Curriculum Experience
- Extra-Curricular Opportunities
- No Senior Pupils
- Leadership and Staffing

In Our Experience: Pitlochry High School

- **Our Context - School Roll**
- **Staffing Structure**
- **Curriculum Experience**
- **Extra-Curricular Opportunities**

Pitlochry High School – Our Context

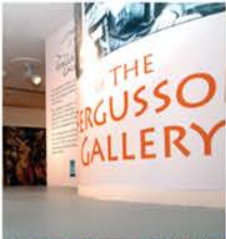

Staffing Structure

- Headteacher, Depute Headteacher (Improvement), Depute Headteacher (Support)

Subjects (members of staff)

- Languages and performing arts
 - English (2), French(2), Drama & Music (1)
- Technologies
 - Technical (1), Computing (1), Art & Design (1)

Staffing Structure (contd)

- **Health & Wellbeing**
 - **Home Economics (1) & PE (1)**
- **Science**
 - **Chemistry(1), Physics(1), Biology(1)**
- **Mathematics (2)**
- **Social subjects**
 - **History (1), Geography (1), Modern Studies**
- **Support for pupils (2)**
- **Learning Resource Centre (2)**

Curriculum Experience

40 Periods x 40 minutes & 10 minutes tutor time everyday

	1	2	3	4	5	6	7	8	9	10	11	12	13	14	15	16	17	18	19	20	21	22	23	24	25	26	27	28	29	30	31	32	33	34	35	36	37	38	39	40	
S1	ENGLISH				MATHS				SOCIALS				ML				SCIENCE				PE		ART		HEC		ICT		TECH		MUSIC		DR		RE		SE		SK		TUTOR
S2	ENGLISH				MATHS				SOCIALS				ML				SCIENCE				PE		ART		HEC		ICT		TECH		MUSIC		DR		RE		SE		SK		
S3	ENGLISH				MATHS				SOCIALS		ML		SCI		EX A		TECH		H & W		FREE choice		FREE Choice		LS		PE		RE		SE										
S4	ENGLISH				MATHS				OPTION 1				OPTION 2				OPTION 3				OPTION 4				OPTION 5				PE		RE		SE								



Extra-Curricular Opportunities

- **School clubs**
- **Supported Study**
- **Wider achievement**
- **Excursions this session**

Pitlochry High School – Our Context



So, what do our Pupils and Parents Think?!



Project Timeline to 2019

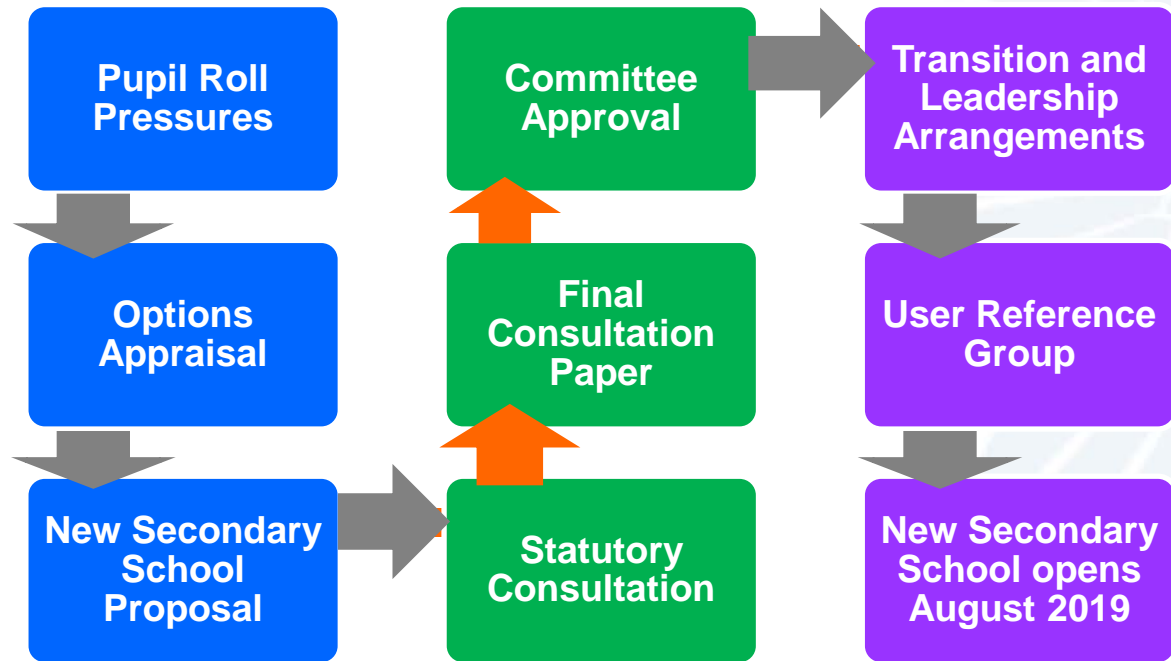

Bertha Park Site



PERTH &
KINROSS
COUNCIL

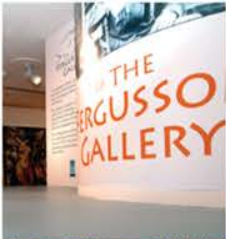

Current School Designs

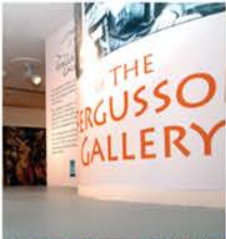

Design approaches

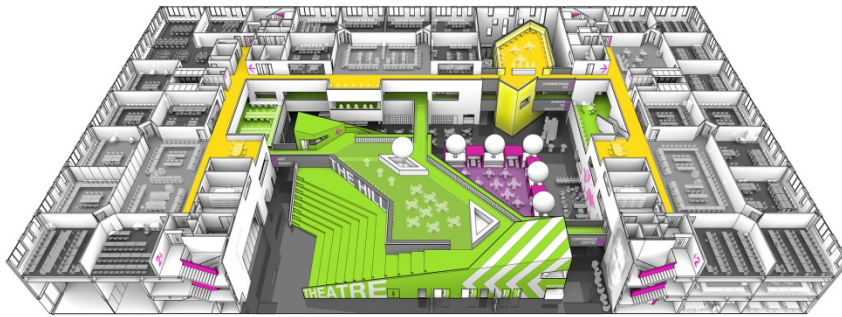
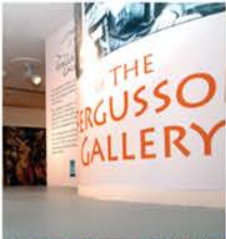

The Deep Plan Approach



Building Envelope

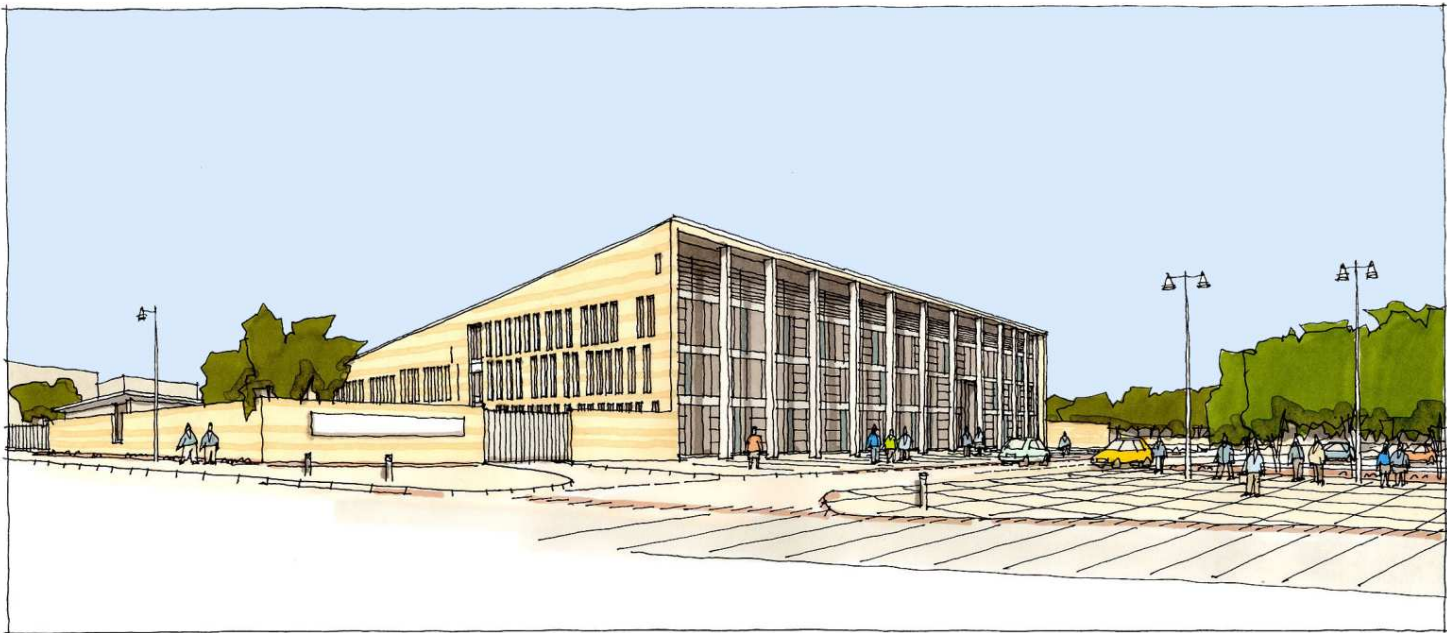

Site Development

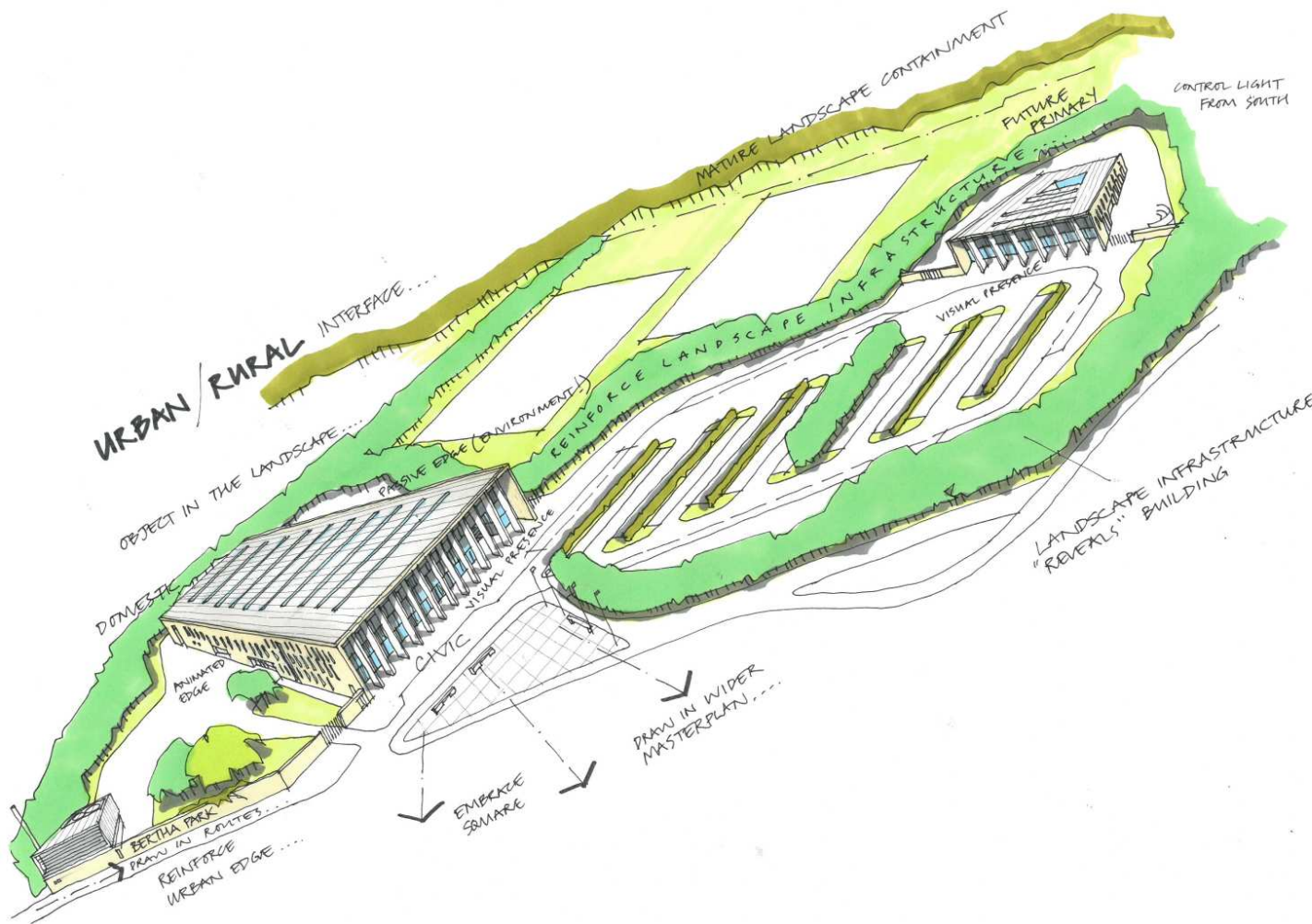

Curricular Requirements

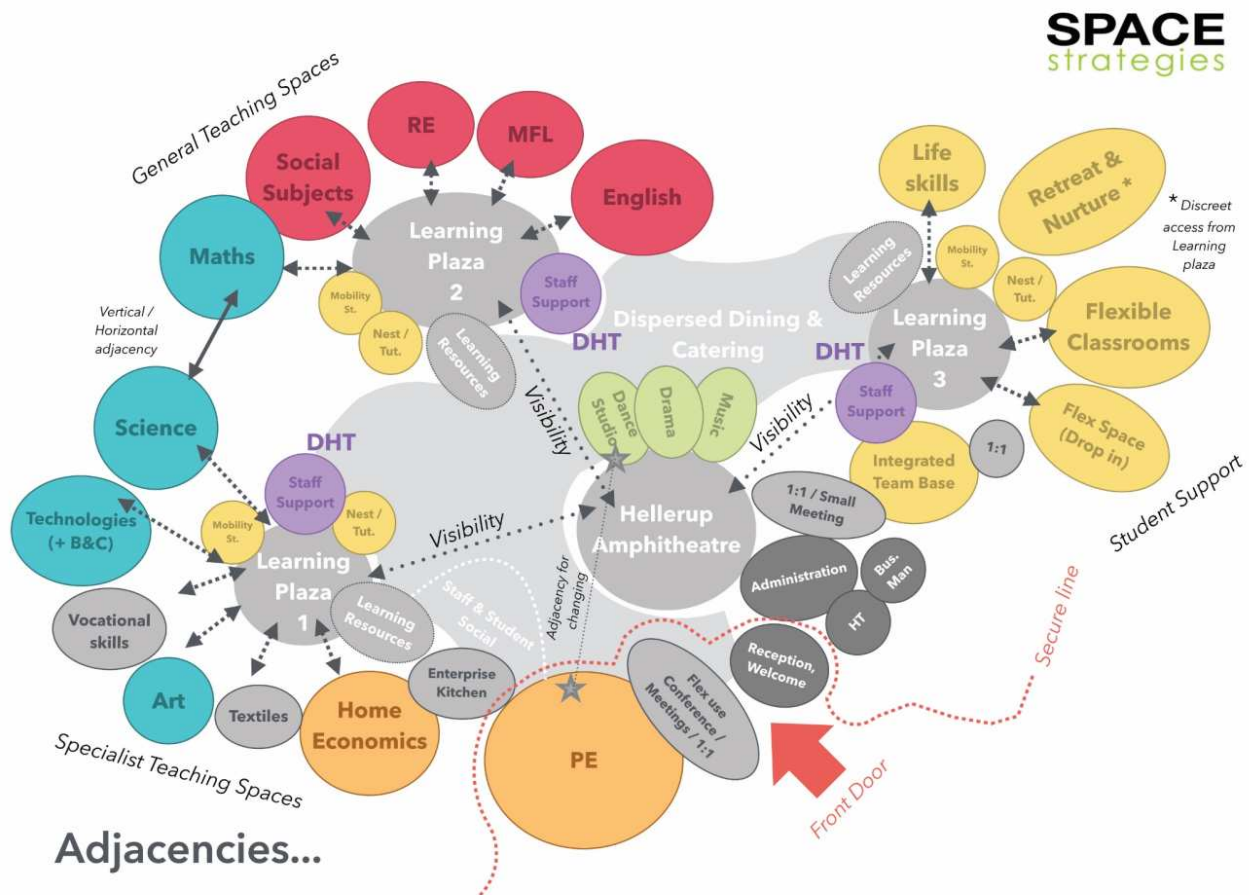

Ground Floor



- Health and Well Being
- STEM, Art, Business & Computing
- Language, Literacy, Social Subjects
- Expressive Arts
- Pupil Support
- Staff Support
- Whole Campus
- Administration and Support
- Infrastructure

INFORMATION	
Project Ref:	AGG14-0101
PKC	Perth Western Secondary
Site Ref:	AL(SK)201
Scale:	A
Drawing:	Ground Floor Plan
Drawn By:	PM/CD
Checked By:	KC
Date:	23/09/2015

ARCHIAL | NORR
 40 Elder Street, Glasgow, G3 8DZ
 T: +44 (0)141 254 8000 F: +44 (0)141 243 4884
 www.archialnorr.com

First Floor



0 10 20 m
First Floor Plan

- Health and Well Being
- STEM, Art, Business & Computing
- Language, Literacy, Social Subjects
- Expressive Arts
- Pupil Support
- Staff Support
- Whole Campus
- Administration and Support
- Infrastructure

INFORMATION	
Project Client:	Perth City
PKC:	Perth Western Secondary Bertha Park
Project No:	IAGG14-0101
Draw No:	ALISK202
Rev:	A
Scale:	1:200 @A1
Drawn By:	PMG
Checked By:	KC
Date:	23/08/2015
Date:	23/08/2015

ARCHIAL | NORR
 81st Street Street, 45 Elliot Street, Glasgow, G3 8JZ
 T: +44 (0)141 224 6000 F: +44 (0)141 240 4004
 www.archialnor.com

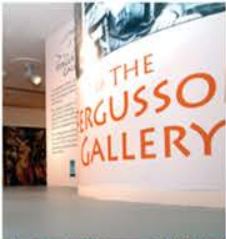

Second Floor

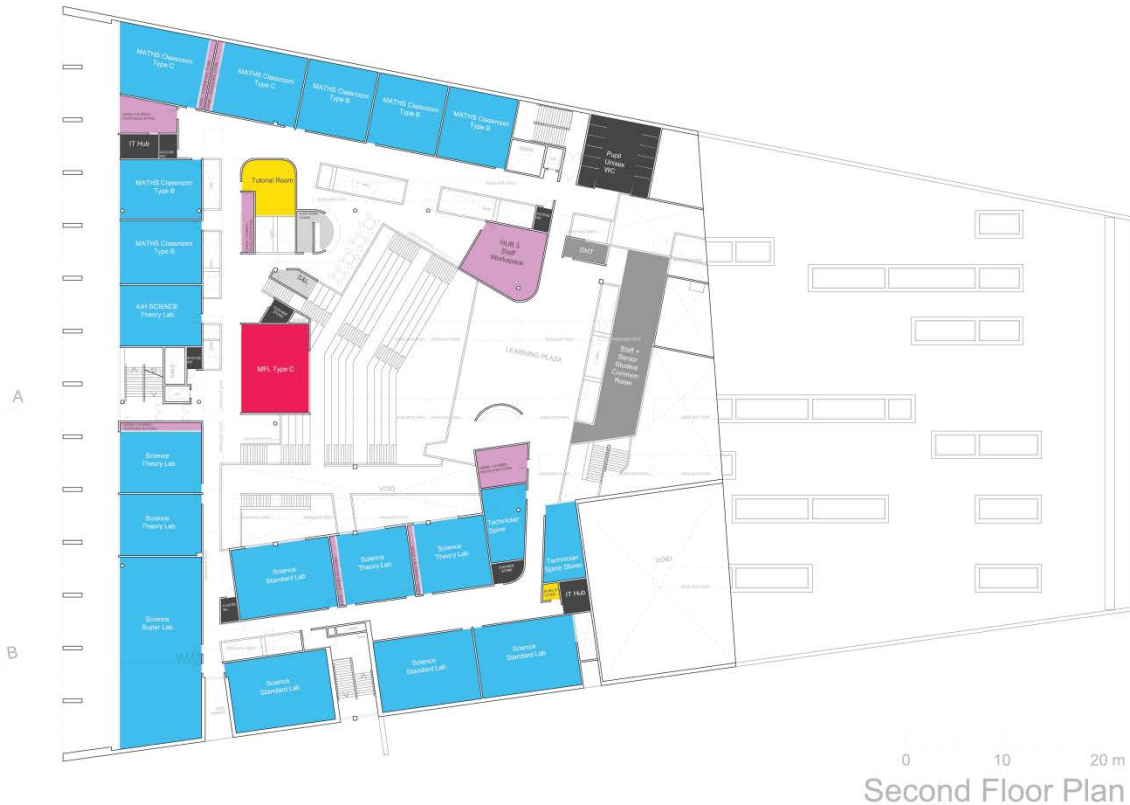

- Health and Well Being
- STEM, Art, Business & Computing
- Language, Literacy, Social Subjects
- Expressive Arts
- Pupil Support
- Staff Support
- Whole Campus
- Administration and Support
- Infrastructure

INFORMATION	
Project Name:	JAG014-0101
Client:	Perth Western Secondary
Location:	Bertha Park
Scale:	A1
Sheet:	1/200
Drawing:	Second Floor Plan
Drawn By:	PKG
Checked By:	AL/SK/203
Date:	23/08/2015
Client Ref:	KC

ARCHIAL | NORR
 Elliot Street Works, 40 Elliot Street, Glasgow, G3 8JZ
 T: +44 (0)141 204 8900 F: +44 (0)141 248 4884
 www.archialnorr.com

Keeping You Informed

- www.pkc.gov.uk
- ECStatutoryConsultations@pkc.gov.uk
- Your Headteacher

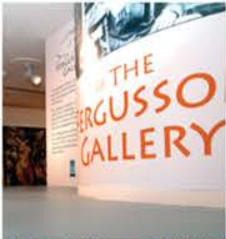

PERTH &
KINROSS
COUNCIL

Questions?