

APPENDIX E – Camp Road Flood Protection Scheme

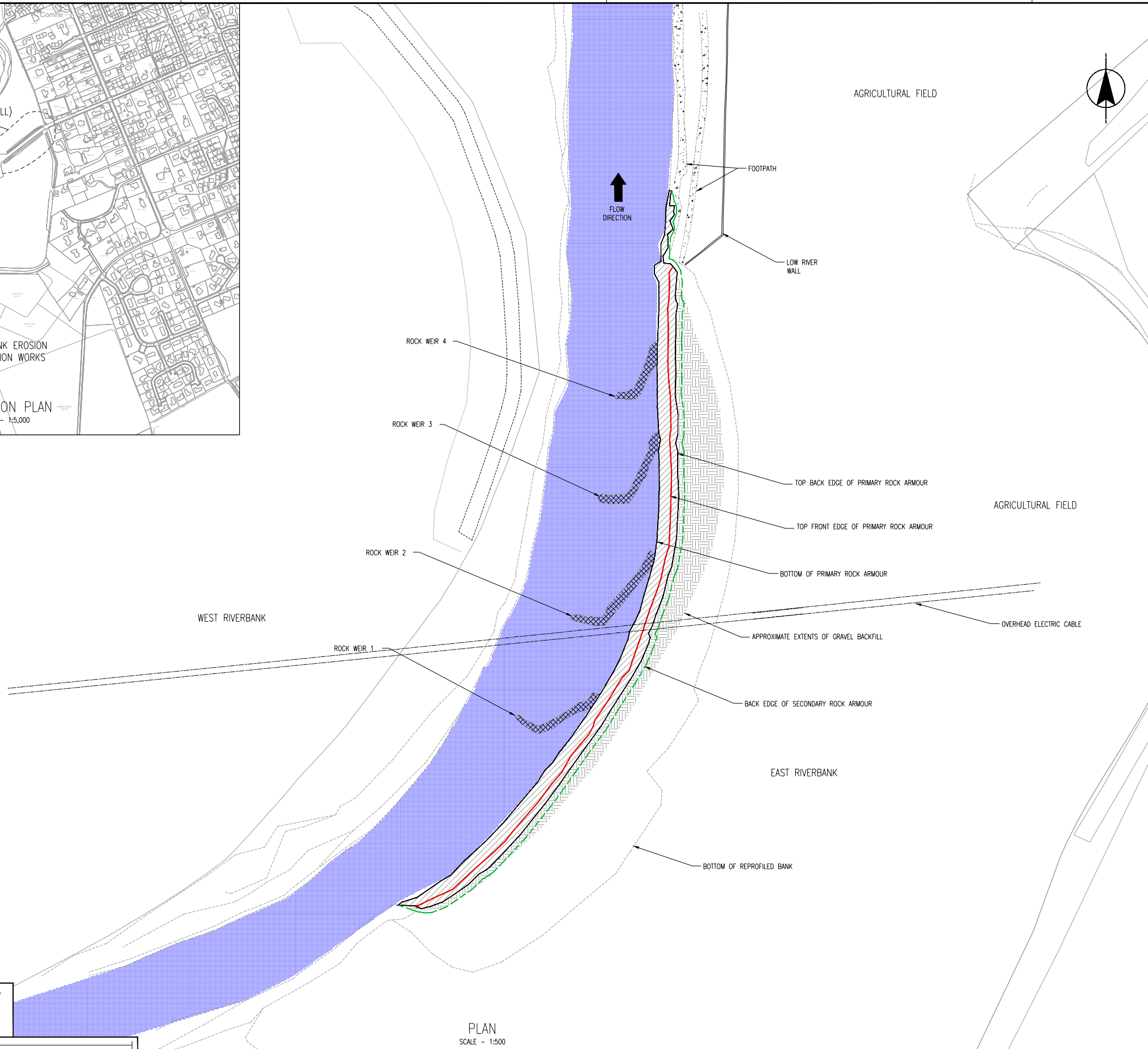
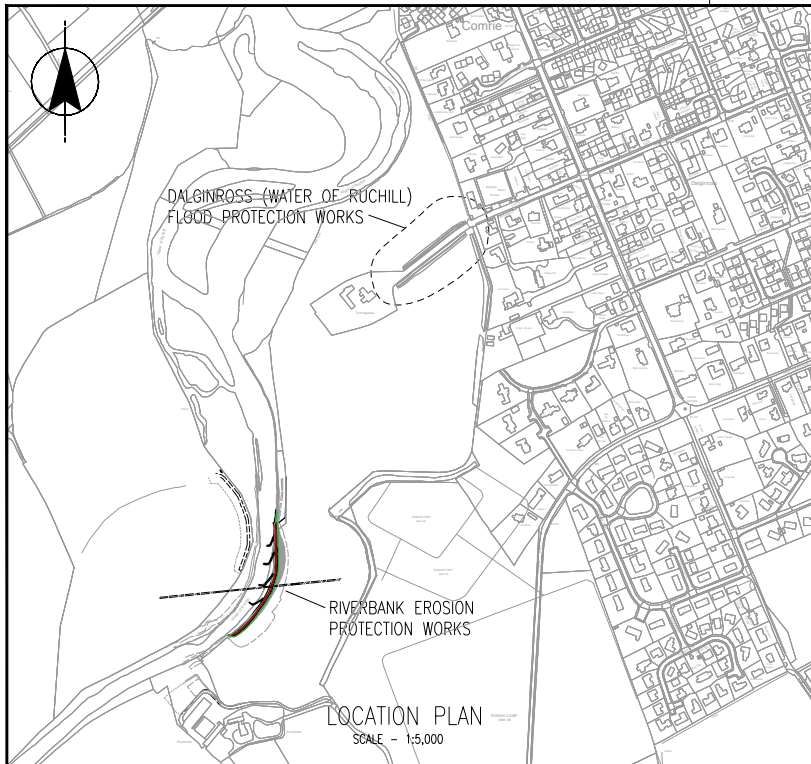

REFERENCE DRAWINGS

- 1033064/020/AB/002 - RUCHILSIDE CROSS SECTIONS 1 OF 3
- 1033064/020/AB/003 - RUCHILSIDE CROSS SECTIONS 2 OF 3
- 1033064/020/AB/004 - RUCHILSIDE CROSS SECTIONS 3 OF 3
- 1033064/020/AB/005 - RUCHILSIDE TYPICAL CROSS SECTION
- 1033064/020/AB/006 - RUCHILSIDE LANDSCAPING PLAN

Reproduced by permission of Ordnance Survey on behalf of Her Majesty's Stationery Office. (c) Crown copyright and database right 2014. All rights reserved. 100016971.

At original drawing size (A1) this line measures 100mm

LEGEND	
	EXTENT OF PRIMARY ROCK ARMOUR REVESTMENT
	GRAVEL BACKFILL
	FOOTPATH
	BED STABILISATION ROCK WEIRS
	TOP FRONT EDGE OF PRIMARY ROCK ARMOUR
	BACK EDGE OF SECONDARY ROCK ARMOUR

Version	Amendment	Drawn Date	Checked Date	Approved Date
Z	AS-BUILT - FINAL	A. BURNE 29.05.14	S. GILLIAND 30.05.14	P. SWIFT 30.05.14
B	AS-BUILT	S. BURRIDGE 30.10.13	S. GILLIAND 30.10.13	P. SWIFT 30.10.13
A	AS-BUILT	J. MCCOFFERY 8.04.13	J. MCDONALD 8.04.13	R. LANG 8.04.13

Client	PERTH & KINROSS COUNCIL
Project	DALGINROSS (WATER OF RUCHILL) FLOOD PROTECTION WORKS
Drawing Title	RUCHILSIDE GENERAL ARRANGEMENT PLAN AS-BUILT

GLASGOW

Tel No
01698 802 850

Scale (at A1 size)	1:500
Purpose of Issue	AS-BUILT
Drawing No	1033064/020/AB/001
Version	Z

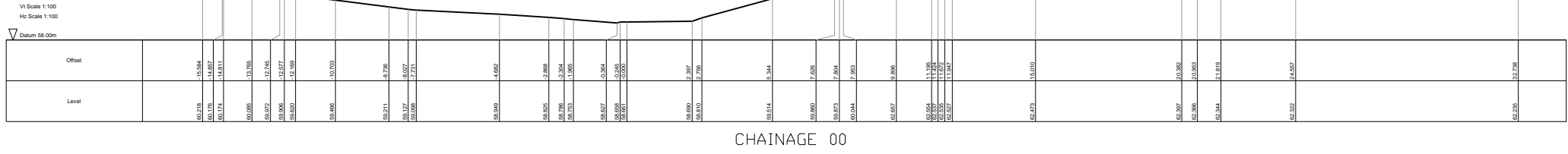

CHAINAGE 00

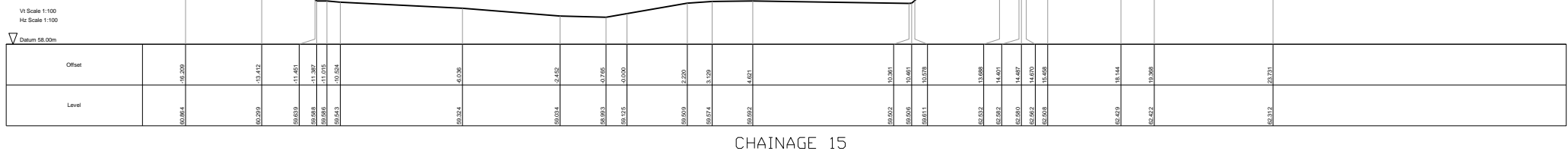

CHAINAGE 15

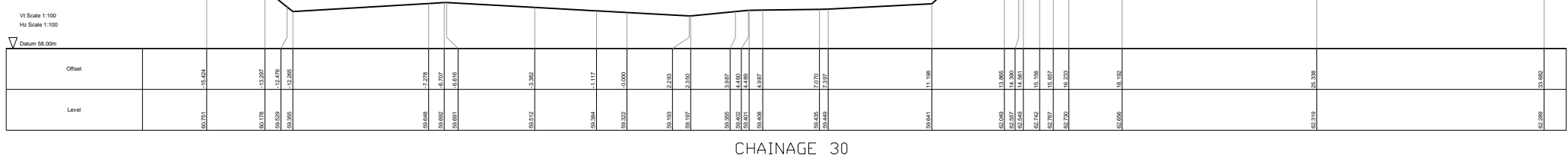

CHAINAGE 30

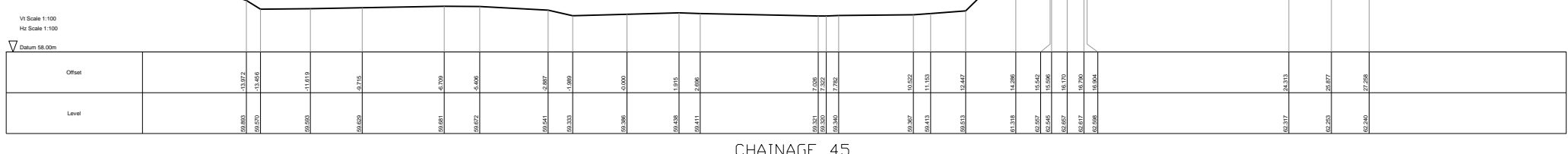

CHAINAGE 45



CHAINAGE 60

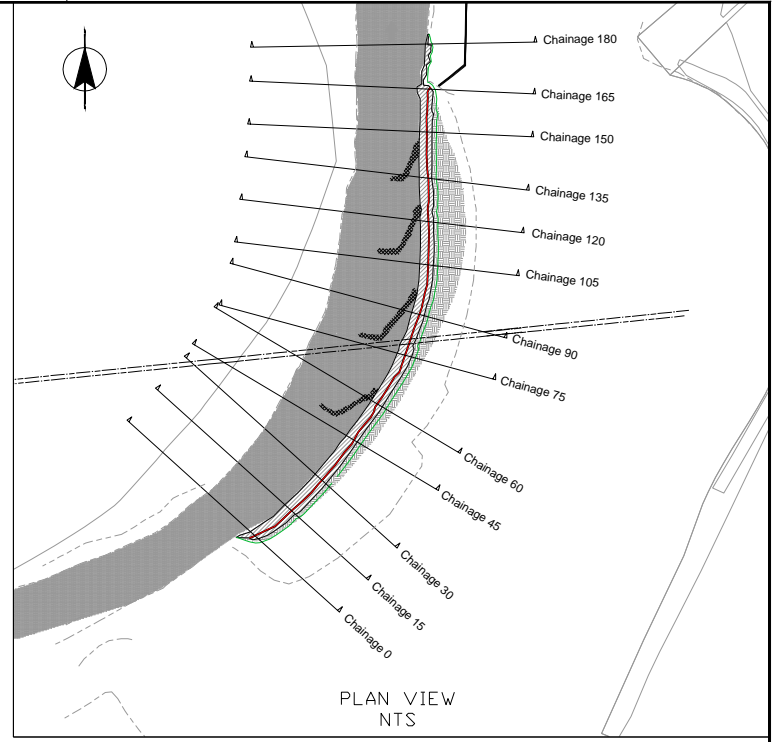

GRID REFERENCE OF CHANNEL CENTRELINE

CROSS SECTION CHAINAGE	EASTING (APPROX)	NORTHING (APPROX)
CH 00	277022.925	720897.057
CH 15	277034.795	720906.552
CH 30	277044.839	720917.693
CH 45	277053.359	720929.959
CH 60	277061.041	720942.842

- REFERENCE DRAWINGS
- 1033064/020/AB/001 - RUCHILSIDE GENERAL ARRANGEMENT PLAN
 - 1033064/020/AB/003 - RUCHILSIDE CROSS SECTION 2 OF 3
 - 1033064/020/AB/004 - RUCHILSIDE CROSS SECTION 3 OF 3
 - 1033064/020/AB/005 - RUCHILSIDE TYPICAL CROSS SECTION
 - 1033064/020/AB/006 - RUCHILSIDE LANDSCAPING PLAN AS-BUILT

Reproduced by permission of Ordnance Survey on behalf of Her Majesty's Stationery Office. (c) Crown copyright and database right 2014. All rights reserved. 100016971.

At original drawing size (A1) this line measures 100mm

NOTES

- ALL LEVELS ARE IN METRES ABOVE ORDNANCE DATUM UNLESS OTHERWISE STATED.
- OFFSETS IN METRES (m).
- ALL GRID REFERENCES ARE RELATIVE TO OS NATIONAL GRID.

Version	Amendment	Drawn Date	Checked Date	Approved Date
Z	AS-BUILT - FINAL	A. BURNE 29.05.14	S O'LLIAND 30.05.14	P SWIFT 30.05.14
B	AS-BUILT	S BURRIDGE 30.10.13	S O'LLIAND 30.10.13	P SWIFT 30.10.13
A	AS-BUILT	J. McCAFFERY 11.04.13	J. MACDONALD 11.04.13	R. LANG 11.04.13

Client: PERTH & KINROSS COUNCIL

Project: DALGINROSS (WATER OF RUCHILL) FLOOD PROTECTION WORKS

Drawing Title: RUCHILSIDE - CROSS SECTIONS 1 OF 3 CHAINAGE 00 - 60

Scale (at A1 size): 1:100

Purpose of Issue: AS-BUILT

Office: GLASGOW

Tel No: 01698 802 850

Drawing No: 1033064/020/AB/002

Version: Z

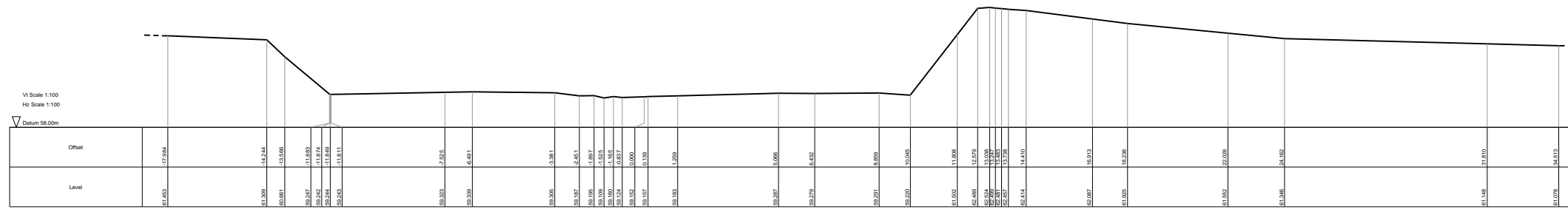
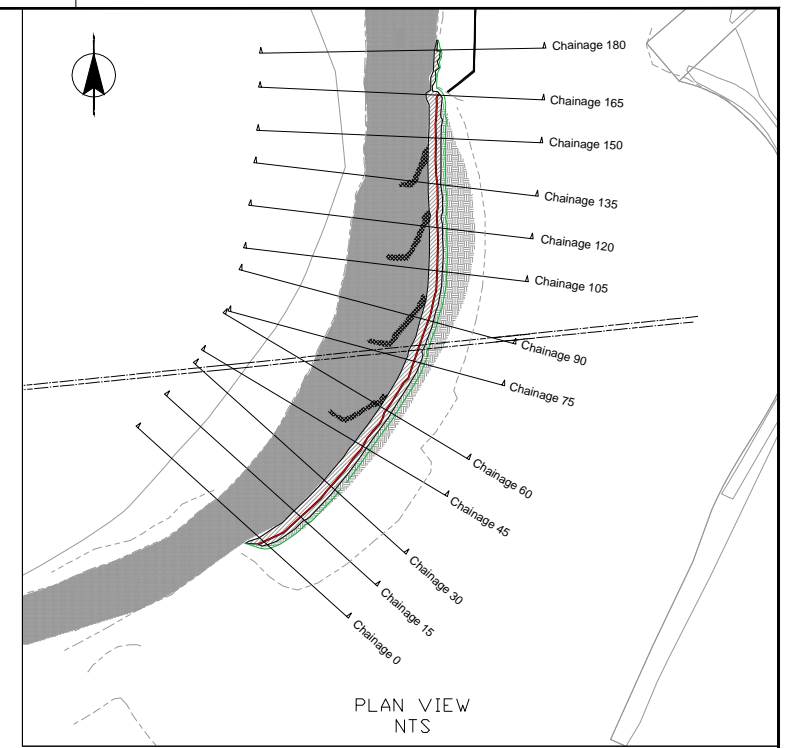

CHAINAGE 150

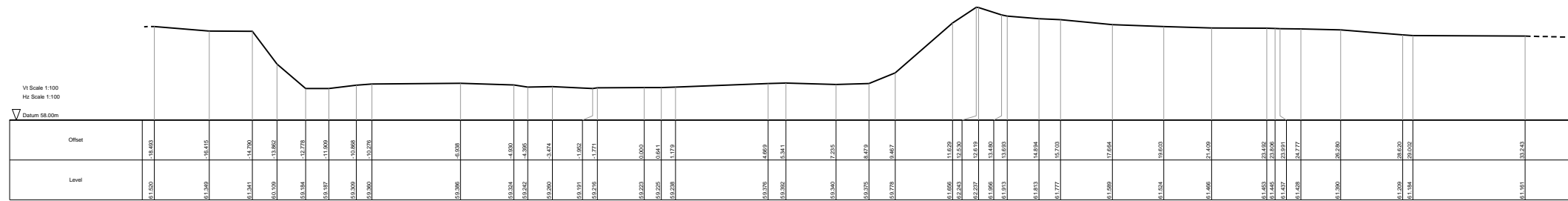

CHAINAGE 165

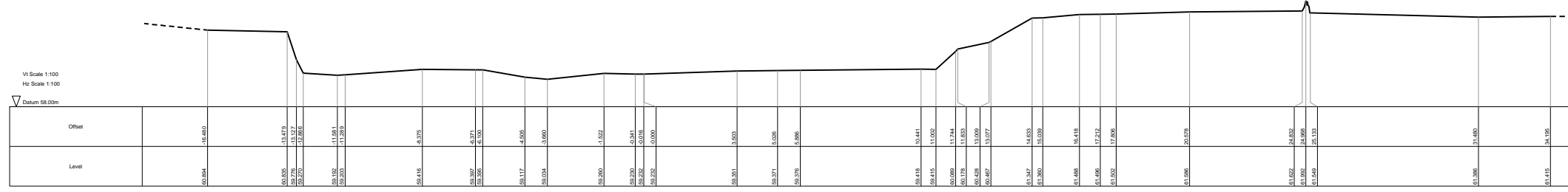

CHAINAGE 180

GRID REFERENCE OF CHANNEL CENTRELINE		
CROSS SECTION CHAINAGE	EASTING (APPROX)	NORTHING (APPROX)
CH 150	277083.877	721029.704
CH 165	277081.058	721044.845
CH 180	277080.778	721059.864

- REFERENCE DRAWINGS
- 1033064/020/AB/001 - RUCHILSIDE GENERAL ARRANGEMENT PLAN
 - 1033064/020/AB/002 - RUCHILSIDE CROSS SECTION 1 OF 3
 - 1033064/020/AB/003 - RUCHILSIDE CROSS SECTION 2 OF 3
 - 1033064/020/AB/005 - RUCHILSIDE TYPICAL CROSS SECTION
 - 1033064/020/AB/006 - RUCHILSIDE LANDSCAPING PLAN AS-BUILT

Reproduced by permission of Ordnance Survey on behalf of Her Majesty's Stationery Office. (c) Crown copyright and database right 2014. All rights reserved. 100016971.

At original drawing size (A1) this line measures 100mm

NOTES			
1. ALL LEVELS ARE IN METRES ABOVE ORDNANCE DATUM UNLESS OTHERWISE STATED. 2. OFFSET IN METRES (m). 3. ALL GRID REFERENCES ARE RELATIVE TO OS NATIONAL GRID.			
Version	Amendment	Drawn Date	Checked Date
Z	AS-BUILT - FINAL	A. BURKE 28.05.14	S O'LLAND 30.05.14
B	AS-BUILT	S BURRIDGE 30.10.13	S O'LLAND 30.10.13
A	AS-BUILT	J. MCCARTHY 11.04.13	J. MACDONALD 11.04.13
		Drawn Date	Checked Date
		Approved Date	Approved Date
Client		PERTH & KINROSS COUNCIL	
Project		DALGINROSS (WATER OF RUCHILL) FLOOD PROTECTION WORKS	
Drawing Title		RUCHILSIDE - CROSS SECTIONS 3 OF 3 CHAINAGE 150 - 180	
Office	Tel No	Drawing No	Version
GLASGOW	01698 802 850	1033064/020/AB/004	Z
Scales (at A1 size)		1:100	
Purpose of Issue		AS-BUILT	

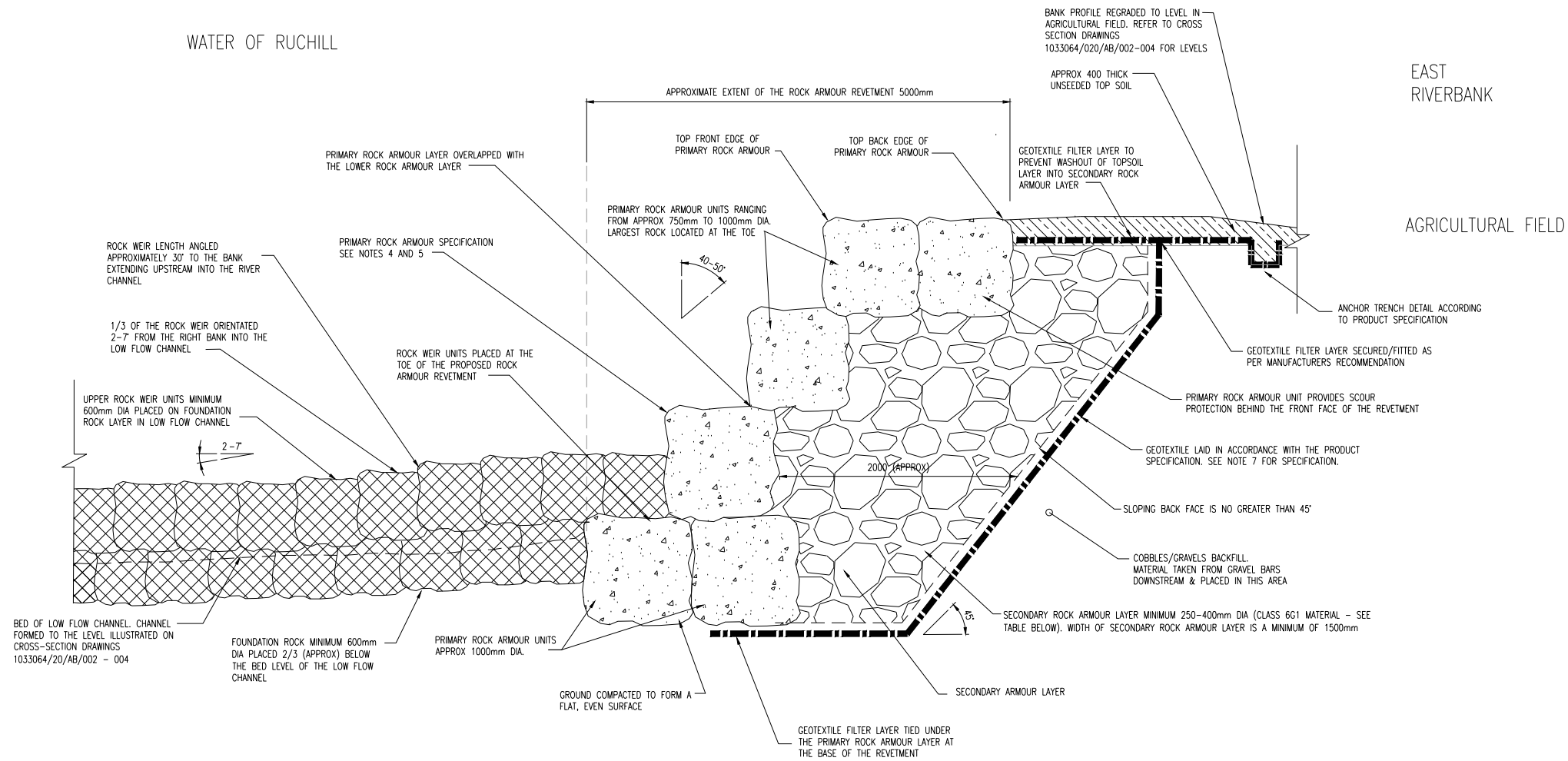

TYPICAL CROSS SECTION AT WEIR
SCALE - 1:25

NOTES

- ALL DIMENSIONS ARE IN MILLIMETRES UNLESS OTHERWISE STATED.
- ALL LEVELS ARE IN METRES ABOVE ORDNANCE DATUM.
- ROCK ARMOUR UNITS SHOWN ARE FOR ILLUSTRATIVE PURPOSES ONLY. QUARRIED ROCK ARMOUR IS MORE IRREGULAR IN SHAPE.
- THE PRIMARY ROCK ARMOUR UNITS MINIMUM DENSITY IS 2650kg/m³.
- THE PRIMARY ROCK ARMOUR UNITS ARE ROUGHLY RECTANGULAR WITH AN ELONGATION RATIO OF 1:3. TRIANGULAR SHAPED ROCK UNITS ARE AVOIDED. MAXIMUM VOID SPACING BETWEEN PRIMARY ROCK ARMOUR UNITS IS 200MM DIA.
- FOUNDATION AND UPPER ROCK UNITS ARE ROUGHLY RECTANGULAR WITH AN ELONGATION RATIO OF 1:3. TRIANGULAR SHAPED ROCK UNITS ARE AVOIDED. MAXIMUM VOID SPACING BETWEEN FOUNDATION AND UPPER ROCK UNITS IS 100MM.
- THE GEOTEXTILE FILTER LAYER SPECIFICATION IS DETAILED BELOW:
(i) A MEAN PEAK TENSILE STRENGTH OF A MINIMUM OF 13KN
(ii) A PORE SIZE OF BETWEEN 0.1mm AND 0.18mm
(iii) THERMALLY BONDED, NON-WOVEN POLYPROPYLENE/POLYETHYLENE MATERIAL
(iv) A PERMEABILITY BS EN ISO 12958:2010 OF BETWEEN 901 m²/s and 1301 m²/s

REFERENCE DRAWINGS

- 1033064/020/AB/001 - RUCHILSIDE GENERAL ARRANGEMENT PLAN
- 1033064/020/AB/002 - CROSS SECTIONS SHEET 1 OF 3
- 1033064/020/AB/003 - CROSS SECTIONS SHEET 2 OF 3
- 1033064/020/AB/004 - CROSS SECTIONS SHEET 3 OF 3
- 1033064/020/AB/006 - RUCHILSIDE LANDSCAPING PLAN

Class	General Material Description	Typical Use	Permitted Constituents Subject to Requirements Clause 601 and Appendix 6/1	(All to Property in Exceptions in Previous Column)	Material Properties Required for Acceptability (In Addition to Requirements on Use of Fill Materials in Clause 601 and Testing in Clause 631)		Compaction Requirements in Clause 612		
					Property (See in Previous Column)	Defined and Tested in Accordance with:		Acceptable Limits within:	
					Lower	Upper			
6	G 1	Selected granular material	Secondary Armour Layer	Natural gravel, crushed rock, crushed concrete or any combination thereof. None of these constituents shall include argillaceous rock.	(i) grading / maximum sizes stated (ii) Los Angeles coefficient	BS1377 : Part 2 (on site) BS EN 933-2 (off site) Cl. 635	250mm 250mm -	400mm 400mm 50	None (but please refer to note 12 on Dwg No. 1033064-020-110)

SECONDARY ROCK ARMOUR CLASS 6G1 SPECIFICATION

At original drawing size (A1) this line measures 100mm

LEGEND 	Z AS-BUILT - FINAL A.BURNE 29.05.14 S.GILLIAND 30.05.14 P.SWIFT 30.05.14	B AS-BUILT S.BURRIDGE 30.10.13 S.GILLIAND 30.10.13 P.SWIFT 30.10.13	A AS-BUILT J.MCCAFFERY 30.04.13 J.MACDONALD 30.04.13 R.IANG 30.04.13	Client: PERTH & KINROSS COUNCIL Project: DALGINROSS (WATER OF RUCHILL) FLOOD PROTECTION WORKS Drawing Title: RUCHILSIDE - TYPICAL CROSS SECTION	 Scales (at A1 size): AS SHOWN Purpose of Issue: AS-BUILT
	Version: _____ Amendment: _____ Drawn Date: _____ Checked Date: _____ Approved Date: _____	Office: GLASGOW Tel No: 01698 802 850 Drawing No: 1033064/020/AB/005 Version: Z			

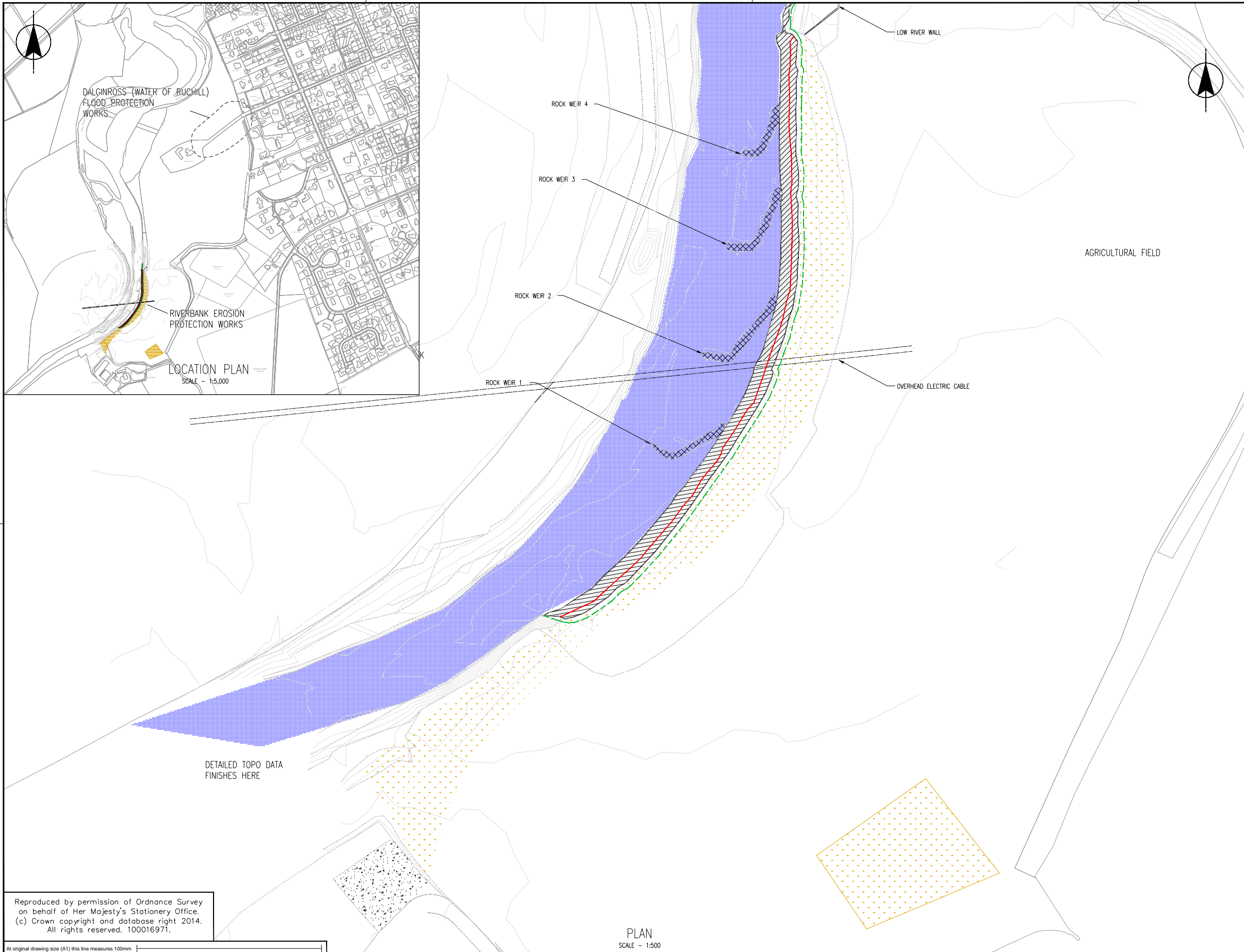

REFERENCES

- 1033064/020/AB/001 - RUCHILSIDE GENERAL ARRANGEMENT PLAN
- 1033064/020/AB/002 - RUCHILSIDE CROSS SECTIONS 1 OF 3
- 1033064/020/AB/003 - RUCHILSIDE CROSS SECTIONS 2 OF 3
- 1033064/020/AB/004 - RUCHILSIDE CROSS SECTIONS 3 OF 3
- 1033064/020/AB/005 - RUCHILSIDE TYPICAL CROSS SECTION

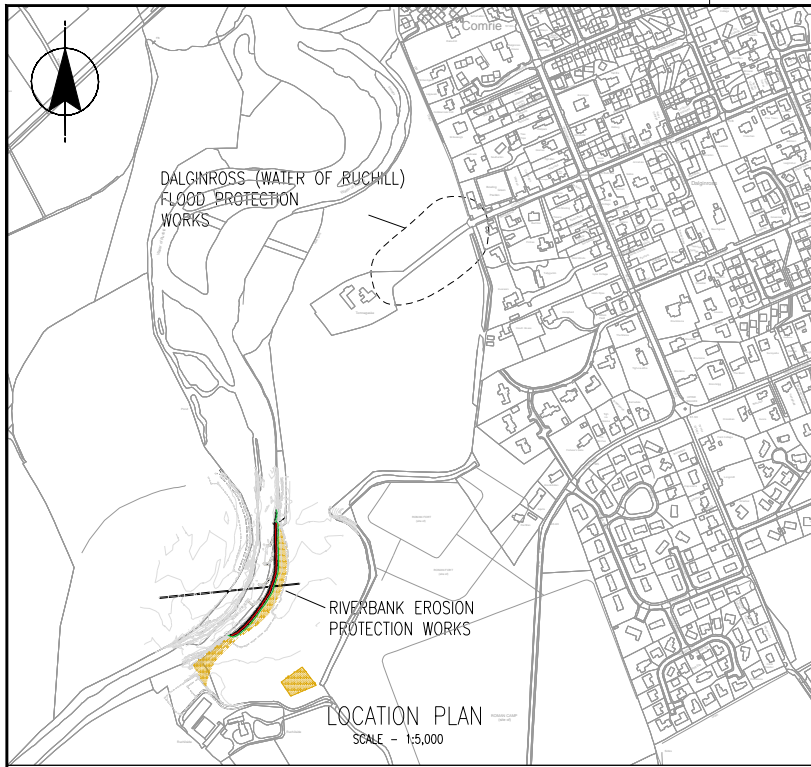

Reproduced by permission of Ordnance Survey on behalf of Her Majesty's Stationery Office. (c) Crown copyright and database right 2014. All rights reserved. 100016971.

At original drawing size (A1) this line measures 100mm

LEGEND	
	EXTENT OF PRIMARY ROCK ARMOUR REVETMENT
	LAND RE-GRADED AND TOPSOILED TO A 400mm DEPTH
	BED STABILISATION ROCK WEIRS
	TYPE 1 HARDSTANDING
	TOP FRONT EDGE OF PRIMARY ROCK ARMOUR
	BACK EDGE OF SECONDARY ROCK ARMOUR

Version	Amendment	Drawn Date	Checked Date	Approved Date
Z	AS-BUILT - FINAL	A BURKE 29.05.14	S GILLIAND 30.05.14	P SWIFT 30.05.14
B	AS-BUILT	S BURRIDGE 30.10.13	S GILLIAND 30.10.13	P SWIFT 30.10.13
A	AS-BUILT	J MCOFFERY 8.04.13	J MCDONALD 8.04.13	R LANG 8.04.13

Client	PERTH & KINROSS COUNCIL
Project	DALGINROSS (WATER OF RUCHILL) FLOOD PROTECTION WORKS
Drawing Title	RUCHILSIDE LANDSCAPING PLAN AS-BUILT

		Scales (at A1 size)	
		1:500	
Office		Tel No	
GLASGOW	01698 802 850	Drawing No	Version
		1033064/020/AB/006	Z

PLAN
SCALE - 1:500

DETAILED TOPO DATA FINISHES HERE

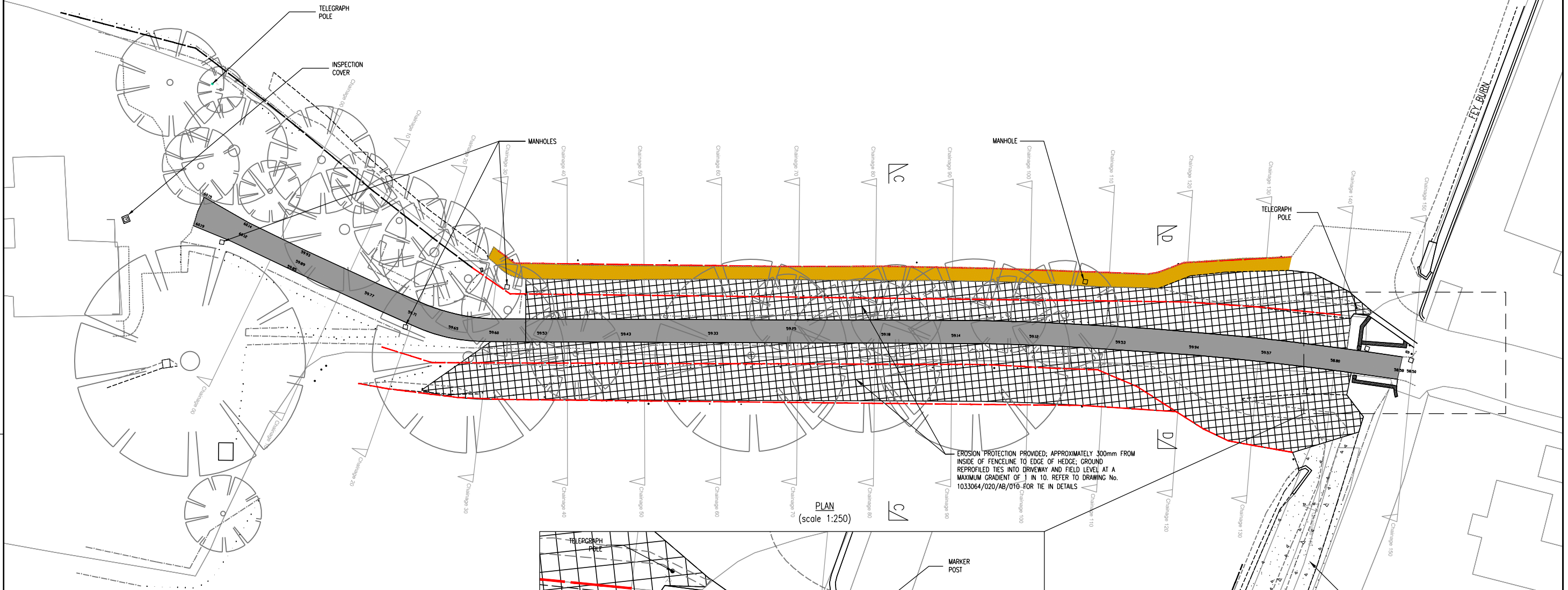

PLAN
(scale 1:250)

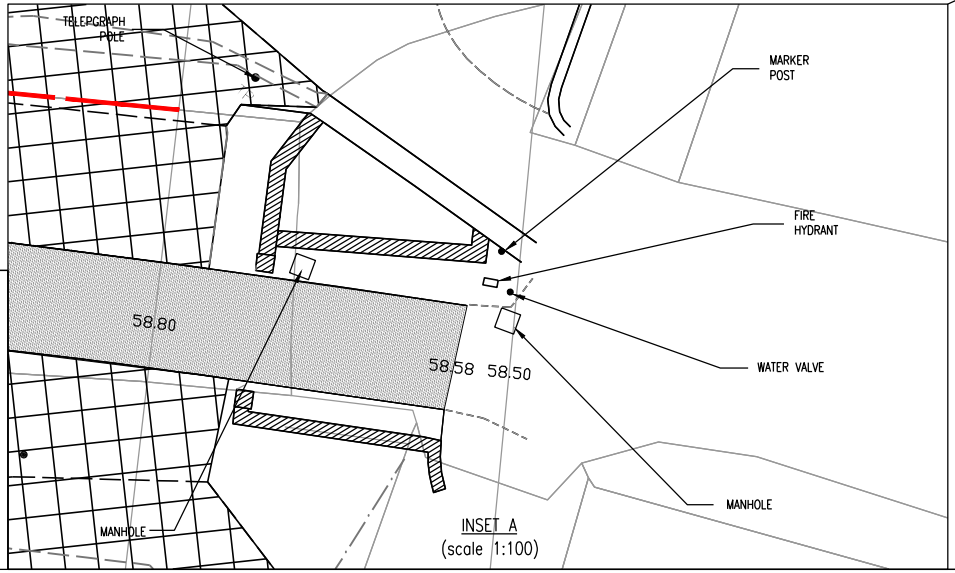

INSET A
(scale 1:100)

NOTES

- GENERAL**
1. ALL DIMENSIONS ARE IN MILLIMETRES UNLESS OTHERWISE STATED.
 2. ALL LEVELS ARE IN METRES ABOVE ORDNANCE DATUM.

REFERENCE DRAWINGS

- 1033064/020/AB/007 - TOMNAGASKE DRIVEWAY - AS BUILT GENERAL ARRANGEMENT
- 1033064/020/AB/008 - TOMNAGASKE DRIVEWAY - AS BUILT TYPICAL CROSS SECTIONS
- 1033064/020/AB/009 - TOMNAGASKE DRIVEWAY - AS BUILT SERVICES
- 1033064/020/AB/010 - TOMNAGASKE DRIVEWAY - AS BUILT GEOTEXTILE CONSTRUCTION DETAILS
- 1033064/020/AB/011 - TOMNAGASKE DRIVEWAY - AS BUILT FLOOD EMBANKMENT TYPICAL CROSS SECTION
- 1033064/020/AB/012 - TOMNAGASKE DRIVEWAY - AS BUILT WALL & GATE POSTS
- 1033064/020/AB/013 - TOMNAGASKE DRIVEWAY - AS BUILT PAVEMENT CONSTRUCTION
- 1033064/020/AB/014 - TOMNAGASKE DRIVEWAY - AS BUILT SURFACING
- 1033064/020/AB/015 - TOMNAGASKE DRIVEWAY - AS BUILT CROSS SECTIONS

Reproduced by permission of Ordnance Survey on behalf of Her Majesty's Stationary Office. (c) Crown copyright and database right 2014. All rights reserved. 100016971.

At original drawing size (A1) this line measures 100mm

SCALE 1:250

LEGEND	
	EROSION PROTECTION
	WALL CONSTRUCTION
	HEDGE
	TREE
	GRAVEL FOOTPATH
	RE-SURFACED AREA
	MANHOLE
	FENCE POSTS
	POST AND WIRE FENCE
	EMBANKMENT REPAIRS

Version	Amendment	Drawn Date	Checked Date	Approved Date
Z	AS-BUILT - FINAL	A.BURNE 29.05.14	S.GILLIAND 30.05.14	P.SWIFT 30.05.14
B	AS-BUILT	S.BURRIDGE 30.10.13	S.GILLIAND 30.10.13	P.SWIFT 30.10.13
A	AS BUILT	J.MCCAFFERY 17.06.13	J.MACDONALD 17.06.13	R.LANG 17.06.13



Client	PERTH & KINROSS COUNCIL
Project	DALGINROSS (WATER OF RUCHILL) FLOOD PROTECTION WORKS
Drawing Title	TOMNAGASKE DRIVEWAY - AS BUILT GENERAL ARRANGEMENT

Office	GLASGOW
Tel No	01698 802 850

Scale (at A1 size)	AS SHOWN
Purpose of Issue	AS BUILT
Drawing No	1033064/020/AB/007
Version	Z

REFERENCE DRAWINGS

- 1033064/020/AB/007 - TOMNAGASKE DRIVEWAY - AS BUILT GENERAL ARRANGEMENT
- 1033064/020/AB/008 - TOMNAGASKE DRIVEWAY - AS BUILT TYPICAL CROSS SECTIONS
- 1033064/020/AB/009 - TOMNAGASKE DRIVEWAY - AS BUILT SERVICES
- 1033064/020/AB/010 - TOMNAGASKE DRIVEWAY - AS BUILT GEOTEXTILE CONSTRUCTION DETAILS
- 1033064/020/AB/011 - TOMNAGASKE DRIVEWAY - AS BUILT FLOOD EMBANKMENT TYPICAL CROSS SECTION
- 1033064/020/AB/012 - TOMNAGASKE DRIVEWAY - AS BUILT WALL & GATE POSTS
- 1033064/020/AB/013 - TOMNAGASKE DRIVEWAY - AS BUILT PAVEMENT CONSTRUCTION
- 1033064/020/AB/014 - TOMNAGASKE DRIVEWAY - AS BUILT SURFACING
- 1033064/020/AB/015 - TOMNAGASKE DRIVEWAY - AS BUILT CROSS SECTIONS

NOTES

1. ALL DIMENSIONS ARE IN MILLIMETRES UNLESS OTHERWISE STATED.
2. ALL LEVELS ARE IN METRES ABOVE ORDNANCE DATUM.
3. EROSION PROTECTION (ENKAMAT 7220 GEOTEXTILE) PROVIDED: APPROXIMATELY 300mm INSIDE FENCELINE TO EDGE OF HEDGELINE; GROUND REPROFILED TO TIE INTO DRIVEWAY AND FIELD LEVEL AT A MAXIMUM GRADIENT OF 1 IN 10.
4. GEOTEXTILE LAID IN ACCORDANCE WITH MANUFACTURERS INSTRUCTIONS. SEE DRAWING No. 1033064/020/AB/010 FOR GEOTEXTILE SPECIFICATION AND TIE IN DETAILS.
5. DRIVEWAY WIDTH VARIES.

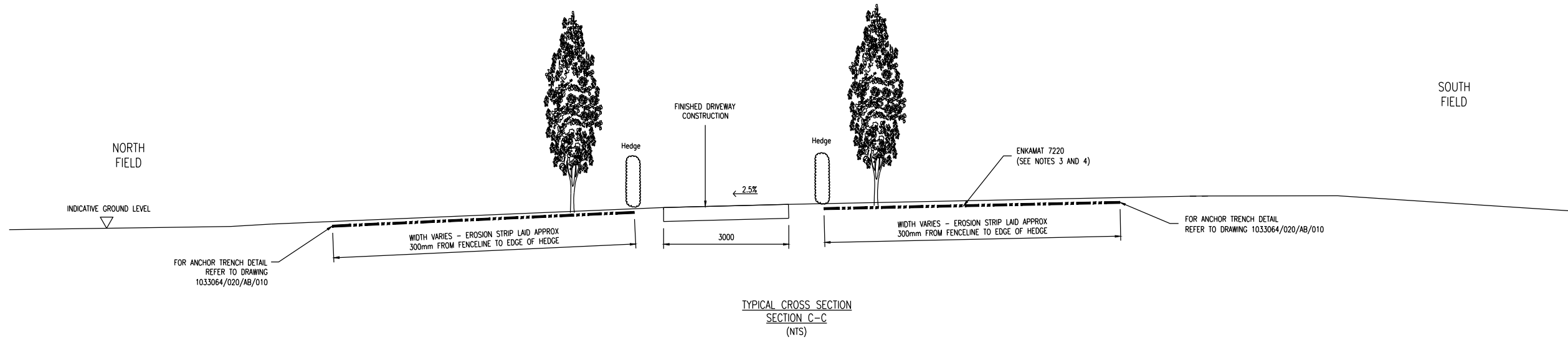

TYPICAL CROSS SECTION
SECTION C-C
(NTS)

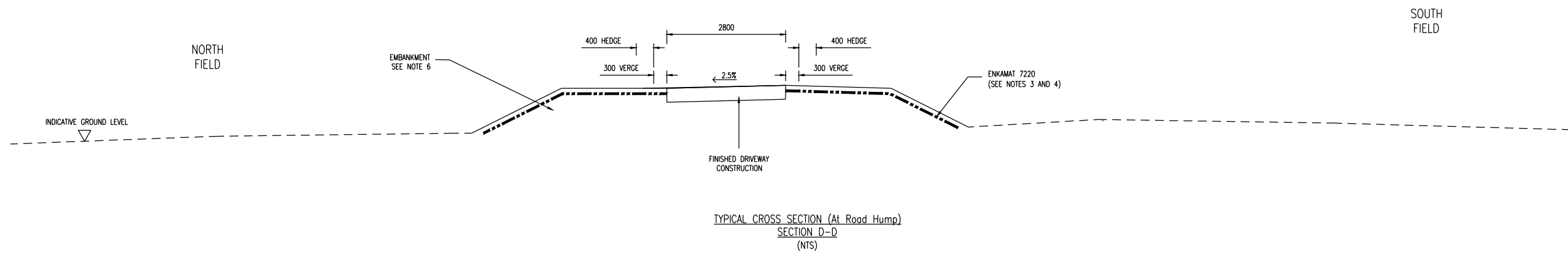

TYPICAL CROSS SECTION (At Road Hump)
SECTION D-D
(NTS)

At original drawing size (A1) this line measures 100mm

LEGEND FINISHED GROUND LEVEL ENKAMAT 7220						Client PERTH & KINROSS COUNCIL				Scales (at A1 size) N.T.S																
		<table border="1" style="width: 100%; border-collapse: collapse;"> <tr> <td>Z</td> <td>AS-BUILT - FINAL</td> <td>A.BURKE 29.05.14</td> <td>S OLLIAND 30.05.14</td> <td>P.SWIFT 30.05.14</td> </tr> <tr> <td>B</td> <td>AS-BUILT</td> <td>S.BURRIDGE 30.10.13</td> <td>S OLLIAND 30.10.13</td> <td>P.SWIFT 30.10.13</td> </tr> <tr> <td>A</td> <td>AS BUILT</td> <td>J.MCCAFFERY 21.06.13</td> <td>J.MCDONALD 21.06.13</td> <td>R.LIANG 21.06.13</td> </tr> <tr> <td>Version</td> <td>Amendment</td> <td>Drawn Date</td> <td>Checked Date</td> <td>Approved Date</td> </tr> </table>				Z	AS-BUILT - FINAL			A.BURKE 29.05.14	S OLLIAND 30.05.14	P.SWIFT 30.05.14	B	AS-BUILT	S.BURRIDGE 30.10.13	S OLLIAND 30.10.13	P.SWIFT 30.10.13	A	AS BUILT	J.MCCAFFERY 21.06.13	J.MCDONALD 21.06.13	R.LIANG 21.06.13	Version	Amendment	Drawn Date	Checked Date
Z	AS-BUILT - FINAL	A.BURKE 29.05.14	S OLLIAND 30.05.14	P.SWIFT 30.05.14																						
B	AS-BUILT	S.BURRIDGE 30.10.13	S OLLIAND 30.10.13	P.SWIFT 30.10.13																						
A	AS BUILT	J.MCCAFFERY 21.06.13	J.MCDONALD 21.06.13	R.LIANG 21.06.13																						
Version	Amendment	Drawn Date	Checked Date	Approved Date																						
Drawing Title TOMNAGASKE DRIVEWAY - AS BUILT TYPICAL CROSS SECTIONS						Office GLASGOW		Tel No 01698 802 850		Drawing No 1033064/020/AB/008																
										Version Z																

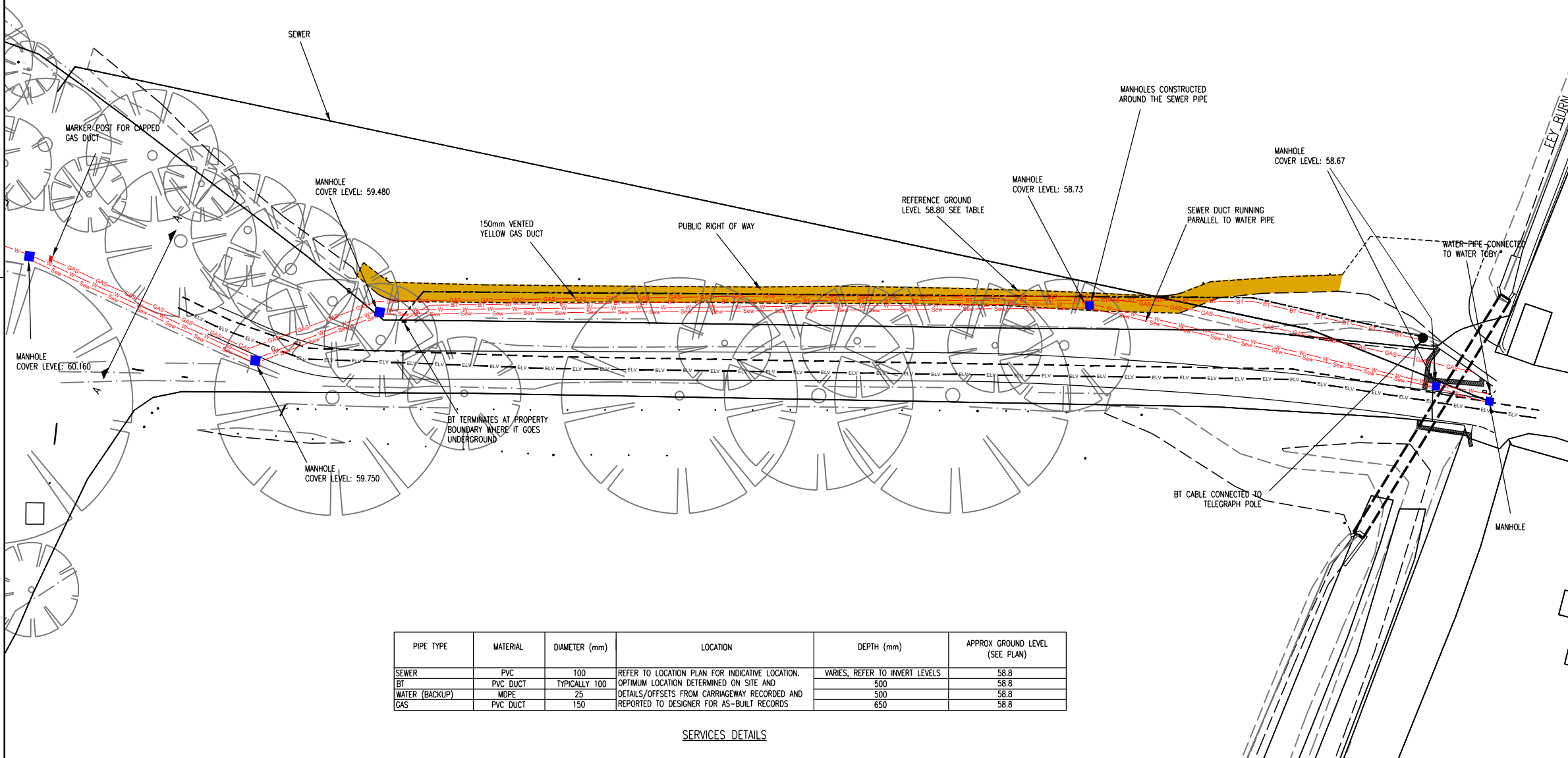
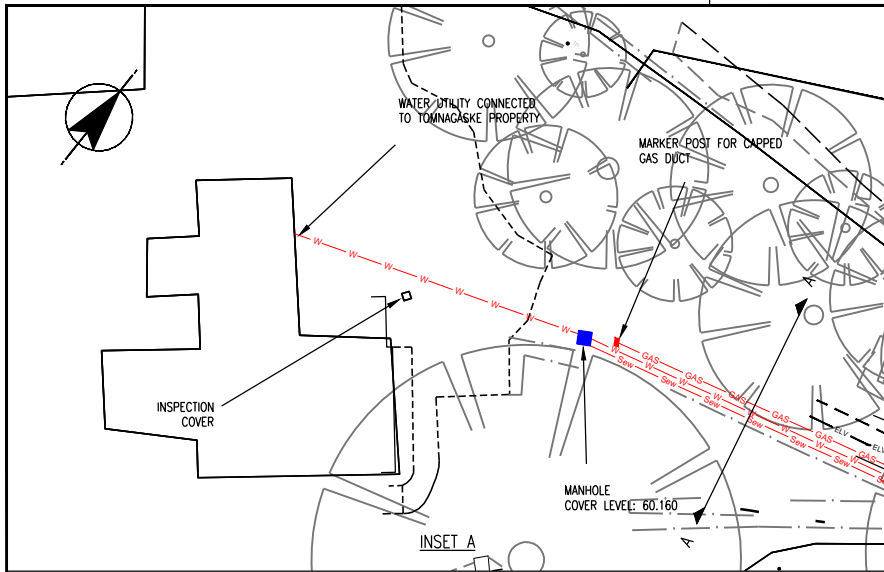

PIPE TYPE	MATERIAL	DIAMETER (mm)	LOCATION	DEPTH (mm)	APPROX GROUND LEVEL (SEE PLAN)
SEWER	PVC	100	REFER TO LOCATION PLAN FOR INDICATIVE LOCATION.	VARIES, REFER TO INVERT LEVELS	58.8
BT	PVC DUCT	TYPICALLY 100	OPTIMUM LOCATION DETERMINED ON SITE AND	500	58.8
WATER (BACKUP)	MDPE	25	DETAILS/OFFSETS FROM CARRIAGEWAY RECORDED AND	500	58.8
GAS	PVC DUCT	150	REPORTED TO DESIGNER FOR AS-BUILT RECORDS	650	58.8

SERVICES DETAILS

NOTES

- ALL DIMENSIONS ARE IN MILLIMETRES UNLESS OTHERWISE STATED.
- ALL LEVELS ARE IN METRES ABOVE ORDNANCE DATUM.
- PIPE PROTECTION DETAILS COMPLY WITH SPECIFICATION FOR HIGHWAY WORKS (S.H.W.); TYPE B - DEEP DUCTS (OVER 1200 COVER)
- PIPE BEDDING MATERIAL COMPLIES WITH CLAUSE 503 OF S.H.W.
- FOR CARRIAGEWAY SURFACING DETAILS, REFER TO DRAWING 1033064/020/AB/014.
- WATER (BACKUP) AND GAS PIPES AND LOCATIONS PROVIDED TO PKC AND LANDOWNER.
- APPROPRIATE BEDDING AND PROTECTION PROVIDED TO BT CABLE DUCT, WATER PIPE, GAS PIPE AND REPLACEMENT SEWER PIPE MEET SERVICE PROVIDERS STANDARD REQUIREMENTS. SEE DRAWING 1033064/020/AB/010 FOR TRENCH AND BEDDING DETAILS.
- MINIMUM DEPTH OF COVER OF 500mm PROVIDED TO BT CABLE DUCT, WATER PIPE (BACKUP) AND GAS PIPE. EXTENT OF DUCTING DETERMINED BY THE CONTRACTOR ON SITE. PIPES LAID IN A TRENCH OFFSET APPROX 4000mm FROM NORTH CHANNEL OF DRIVEWAY TO AVOID TREE ROOTS. SEE DRAWING 1033064/020/AB/010 FOR TRENCH AND BEDDING DETAILS.
- CULVERT (FEY BURN) UNDER DRIVEWAY INCLUDING INLET AND OUTLET RETAINED.
- WATER PIPE AND ELECTRIC CABLE IN DRIVEWAY RETAINED.
- SERVICES DETAILS TABLE DEPTH PROVIDED BY CONTRACTOR.
- WHERE GAS DUCT CHANGES DIRECTION, A MINIMUM RADIUS OF 2m ACHIEVED.
- ALL SERVICES AND MANHOLES KEPT WITHIN FENCELINE.

REFERENCE DRAWINGS

- 1033064/020/AB/007 - TOMNAGASKE DRIVEWAY - AS BUILT GENERAL ARRANGEMENT
- 1033064/020/AB/008 - TOMNAGASKE DRIVEWAY - AS BUILT TYPICAL CROSS SECTIONS
- 1033064/020/AB/009 - TOMNAGASKE DRIVEWAY - AS BUILT SERVICES
- 1033064/020/AB/010 - TOMNAGASKE DRIVEWAY - AS BUILT GEOTEXTILE CONSTRUCTION DETAILS
- 1033064/020/AB/011 - TOMNAGASKE DRIVEWAY - AS BUILT FLOOD EMBANKMENT TYPICAL CROSS SECTION
- 1033064/020/AB/012 - TOMNAGASKE DRIVEWAY - AS BUILT WALL & GATE POSTS
- 1033064/020/AB/013 - TOMNAGASKE DRIVEWAY - AS BUILT PAVEMENT CONSTRUCTION
- 1033064/020/AB/014 - TOMNAGASKE DRIVEWAY - AS BUILT SURFACING
- 1033064/020/AB/015 - TOMNAGASKE DRIVEWAY - AS BUILT CROSS SECTIONS

Reproduced by permission of Ordnance Survey on behalf of Her Majesty's Stationery Office. (c) Crown copyright and database right 2014. All rights reserved. 100016971.

PLAN
(scale 1:250)

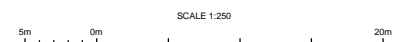

LEGEND	
Sewer	SEWER DUCT
W	WATER DUCT (BACKUP)
GAS	GAS DUCT
BT	BT DUCT
	CULVERT
	SEWER
	WATER
	BT
	ELECTRICITY
	TELEGRAPH POLE
	MANHOLE
	FENCE

Version	Amendment	Drawn Date	Checked Date	Approved Date
Z	AS-BUILT - FINAL	A.BURKE 29.05.14	S.GILLAND 30.05.14	P.SWIFT 30.05.14
B	AS-BUILT	S.BURROUGE 30.10.13	S.GILLAND 30.10.13	P.SWIFT 30.10.13
A	AS BUILT	J.MCCAFFERTY 21/06/13	J.MCCONNELL 21/06/13	R.LANG 21/06/13

Client	PERTH & KINROSS COUNCIL
Project	DALGINROSS (WATER OF RUCHILL) FLOOD PROTECTION WORKS
Drawing Title	TOMNAGASKE DRIVEWAY - AS BUILT SERVICES

Scales (at A1 size)	
AS SHOWN	AS BUILT
Purpose of Issue	
Office	Tel No
GLASGOW	01698 802 850
Drawing No	Version
1033064/020/AB/009	Z

NOTES

1. ALL DIMENSIONS ARE IN MILLIMETRES UNLESS OTHERWISE STATED.
2. ALL LEVELS ARE IN METRES ABOVE ORDNANCE DATUM.
3. ALL GEOTEXTILES LAID IN ACCORDANCE WITH MANUFACTURERS' INSTRUCTIONS.
4. ENKAMAT CUT TO SUIT AROUND TREES/HEDGE TRUNKS. ENKAMAT CUT TO LEAVE A 100mm GAP AROUND THE CIRCUMFERENCE OF THE TRUNK. CUT ENKAMAT NOT BUTTED UP TO EACH ROLL BUT LAPPED BY A MIN OF 300mm.
5. ALL TOPSOIL SOURCED LOCALLY. 50mm LAYER BELOW GEOTEXTILE SEEDED WITH BRITISH SEED HOUSES AMENITY MIX A18; SOWING RATE 35g/m².
6. A MINIMUM LATERAL CLEARANCE OF 250MM MAINTAINED BETWEEN GAS DUCT AND ANY OTHER UTILITIES.

REFERENCE DRAWINGS

- 1033064/020/AB/007 - TOMNAGASKE DRIVEWAY - AS BUILT GENERAL ARRANGEMENT
- 1033064/020/AB/008 - TOMNAGASKE DRIVEWAY - AS BUILT TYPICAL CROSS SECTIONS
- 1033064/020/AB/009 - TOMNAGASKE DRIVEWAY - AS BUILT SERVICES
- 1033064/020/AB/010 - TOMNAGASKE DRIVEWAY - AS BUILT GEOTEXTILE CONSTRUCTION DETAILS
- 1033064/020/AB/011 - TOMNAGASKE DRIVEWAY - AS BUILT FLOOD EMBANKMENT TYPICAL CROSS SECTION
- 1033064/020/AB/012 - TOMNAGASKE DRIVEWAY - AS BUILT WALL & GATE POSTS
- 1033064/020/AB/013 - TOMNAGASKE DRIVEWAY - AS BUILT PAVEMENT CONSTRUCTION
- 1033064/020/AB/014 - TOMNAGASKE DRIVEWAY - AS BUILT SURFACING
- 1033064/020/AB/015 - TOMNAGASKE DRIVEWAY - AS BUILT CROSS SECTIONS

ENKAMAT LAID PARALLEL TO THE ROAD WITH THE OVERLAPS LAID WITH THE DIRECTION OF FLOW I.E. SOUTH OVER NORTH. ENKAMAT LAID FROM EDGE OF HEDGELINE TO A DISTANCE OF APPROXIMATELY 300mm FROM FENCELINE.

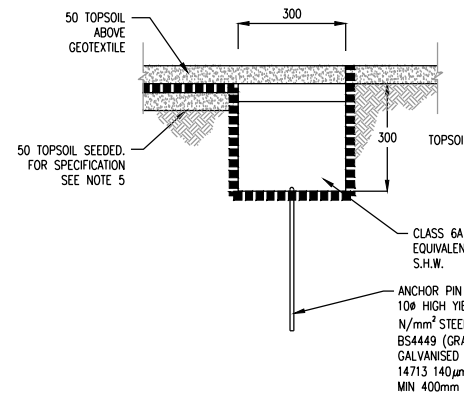

STANDARD EDGE ARRANGEMENT
(Scale 1:10)

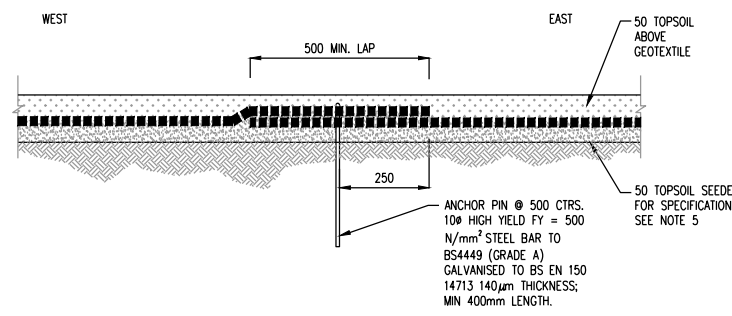

ENKAMAT OVERLAP STANDARD DETAIL
(Scale 1:10)

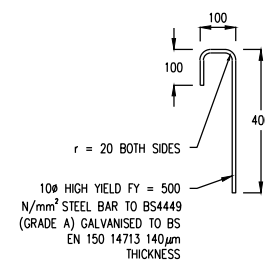

ANCHOR PIN DETAIL
(Scale 1:10)

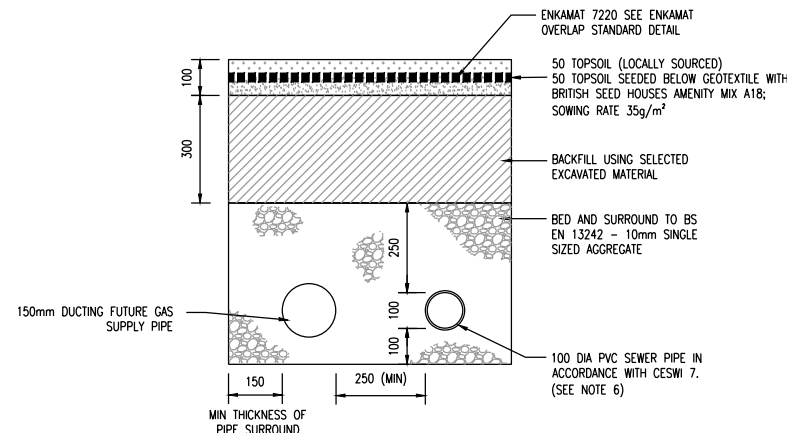

SEWER & GAS BEDDING DETAIL
(Scale 1:10)

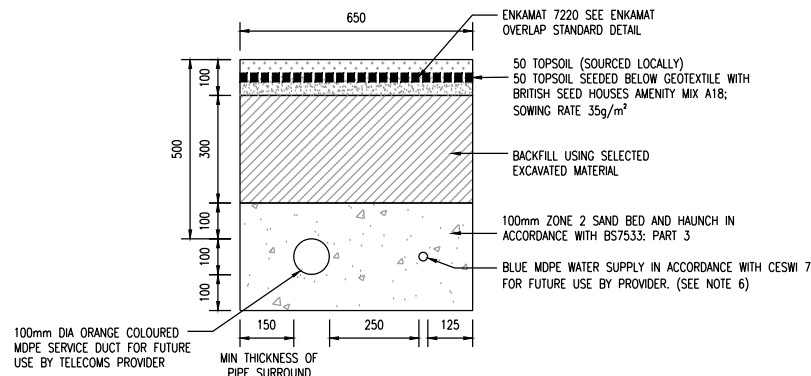

WATER & TELECOMMS BEDDING DETAIL
(Scale 1:10)

At original drawing size (A1) this line measures 100mm

LEGEND	
	ENKAMAT 7220
	TOPSOIL (SOURCED LOCALLY)
	SEEDED TOPSOIL
	BACKFILL MATERIAL
	SINGLE SIZED AGGREGATE
	SAND
	GROUND

Version	Amendment	Drawn Date	Checked Date	Approved Date
Z	AS-BUILT - FINAL	A.BURKE 29.05.14	S.GILLIAND 30.05.14	P.SWIFT 30.05.14
B	AS-BUILT	S.BURRIDGE 30.10.13	S.GILLIAND 30.10.13	P.SWIFT 30.10.13
A	AS BUILT	J.MCCAFFERY 21.06.13	J.MCDONALD 21.06.13	R.LANG 21.06.13



Client	PERTH & KINROSS COUNCIL
Project	DALGINROSS (WATER OF RUCHILL) FLOOD PROTECTION WORKS
Drawing Title	TOMNAGASKE DRIVEWAY - AS BUILT GEOTEXTILE CONSTRUCTION DETAILS

		Scales (at A1 size)	
		AS SHOWN	
		Purpose of Issue	
		AS BUILT	
Office	Tel No	Drawing No	Version
GLASGOW	01698 802 850	1033064/020/AB/010	Z

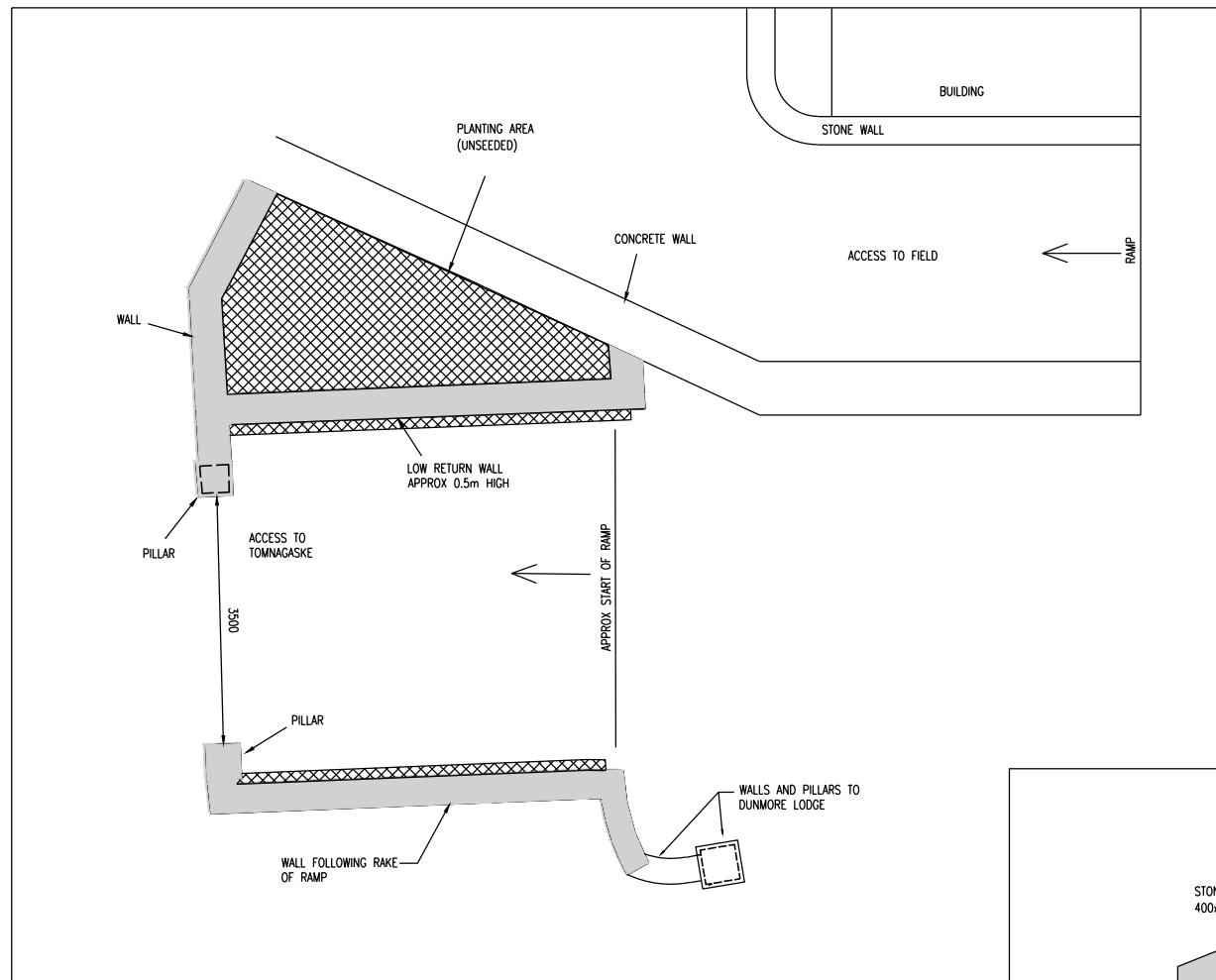

PLAN
SCALE 1:50

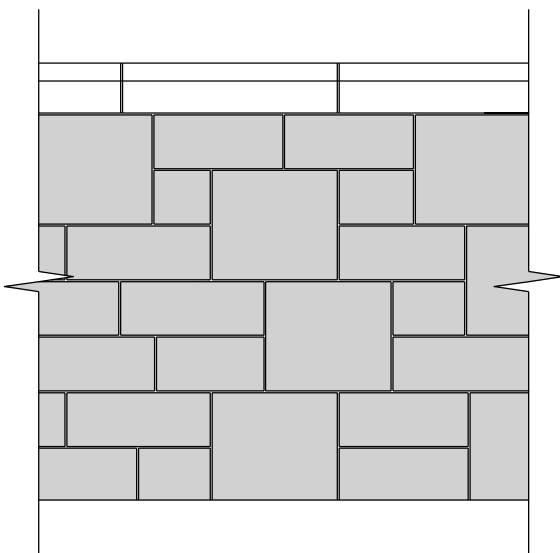

WALL ELEVATION
SCALE 1:10

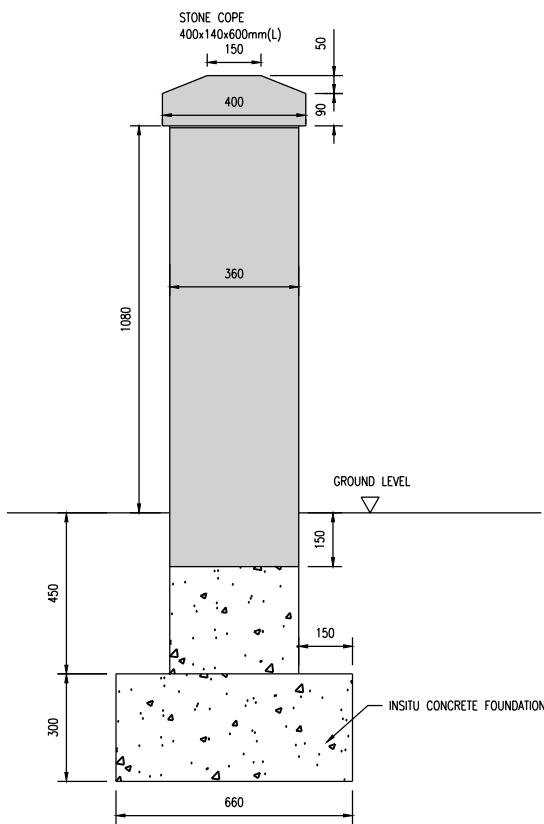

SECTION THROUGH WALL
SCALE 1:10

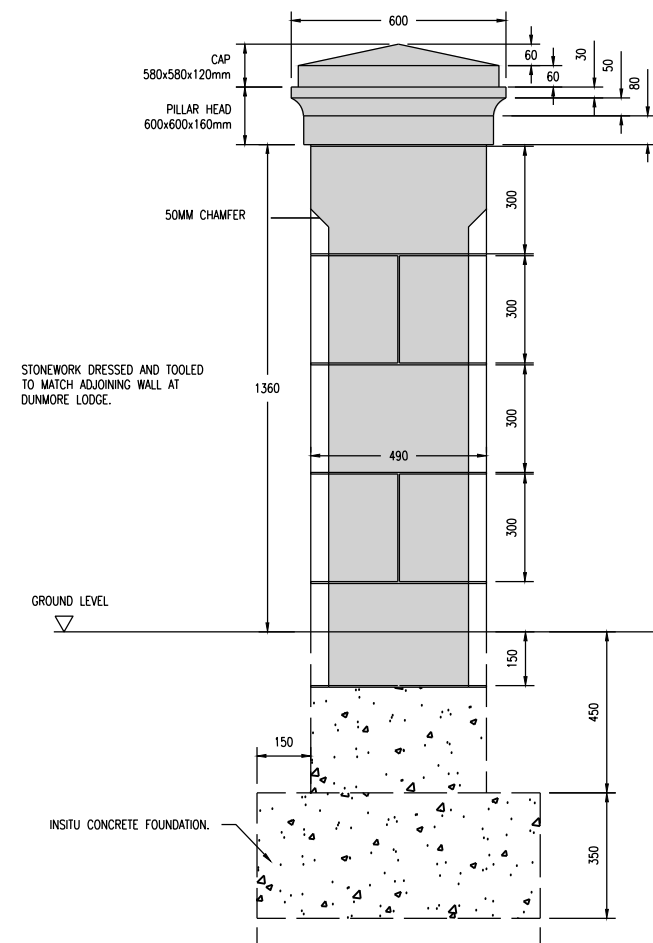

SECTION THROUGH STONE PILLAR
SCALE 1:10

NOTES

1. DRESSED SANDSTONE BLOCKS (RANDOM LENGTH) IN 150 & 300mm COURSES.
2. FACE OF STONEMWORK STUGGED AND TOOLED TO MATCH ADJOINING WALL AT DUNMORE LODGE.

REFERENCE DRAWINGS

- 1033064/020/AB/007 - TOMNAGASKE DRIVEWAY - AS BUILT GENERAL ARRANGEMENT
- 1033064/020/AB/008 - TOMNAGASKE DRIVEWAY - AS BUILT TYPICAL CROSS SECTIONS
- 1033064/020/AB/009 - TOMNAGASKE DRIVEWAY - AS BUILT SERVICES
- 1033064/020/AB/010 - TOMNAGASKE DRIVEWAY - AS BUILT GEOTEXTILE CONSTRUCTION DETAILS
- 1033064/020/AB/011 - TOMNAGASKE DRIVEWAY - AS BUILT FLOOD EMBANKMENT TYPICAL CROSS SECTION
- 1033064/020/AB/012 - TOMNAGASKE DRIVEWAY - AS BUILT WALL & GATE POSTS
- 1033064/020/AB/013 - TOMNAGASKE DRIVEWAY - AS BUILT PAVEMENT CONSTRUCTION
- 1033064/020/AB/014 - TOMNAGASKE DRIVEWAY - AS BUILT SURFACING
- 1033064/020/AB/015 - TOMNAGASKE DRIVEWAY - AS BUILT CROSS SECTIONS

At original drawing size (A1) this line measures 100mm

LEGEND

- PILLAR/WALL CONSTRUCTION
- PLANTING AREA
- CONCRETE FOUNDATION

Version	Amendment	Drawn Date	Checked Date	Approved Date
Z	AS-BUILT - FINAL	A.BURKE 29.05.14	S.GILLIAND 30.05.14	P.SWIFT 30.05.14
B	AS-BUILT	S.BURRIDGE 30.10.13	S.GILLIAND 30.10.13	P.SWIFT 30.10.13
A	AS BUILT	J.MCCAFFERY 21.06.13	J.MCDONALD 21.06.13	R.LANG 21.06.13



Client	PERTH & KINROSS COUNCIL
Project	DALGINROSS (WATER OF RUCHILL) FLOOD PROTECTION WORKS
Drawing Title	TOMNAGASKE DRIVEWAY - AS BUILT SANDSTONE WALL AND GATEPOST

Scales (at A1 size)		AS SHOWN
Purpose of Issue		AS BUILT
Office	Tel No	Drawing No
GLASGOW	01698 802 850	1033064/020/AB/012
Version		Z



NORTH FIELD

SOUTH FIELD

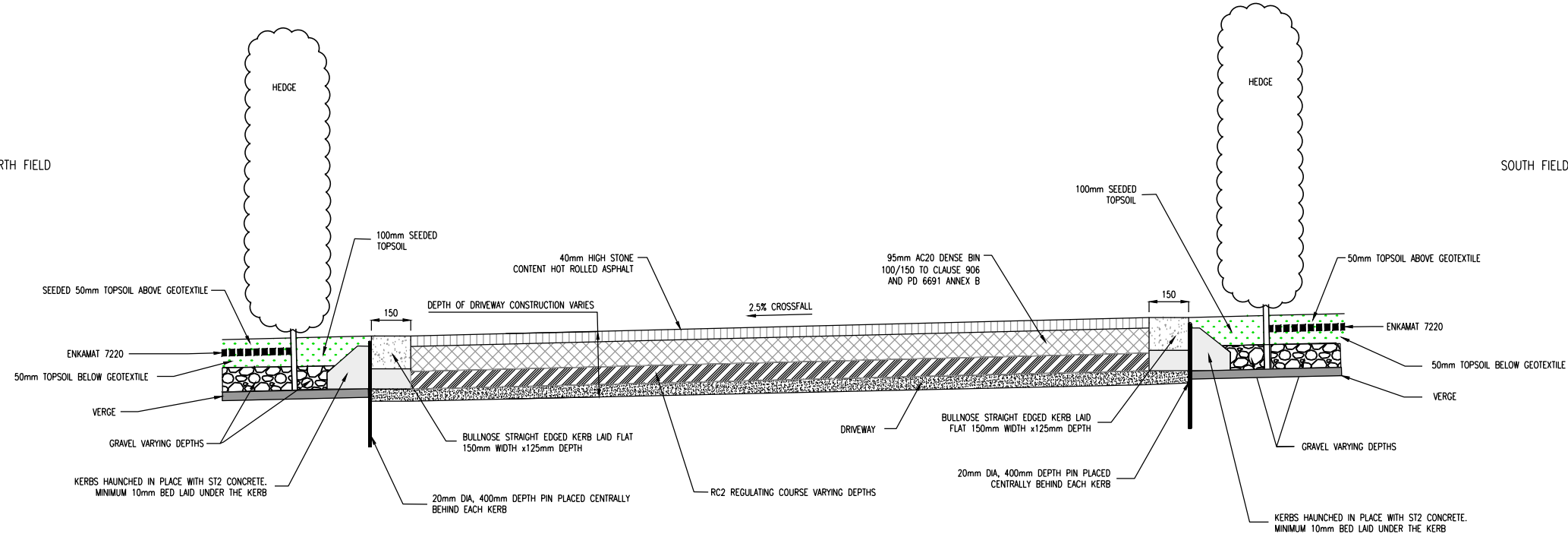

OVERLAY - STANDARD DETAIL APPLIED BETWEEN Ch 15 to Ch 100

(NTS)

NORTH FIELD

SOUTH FIELD

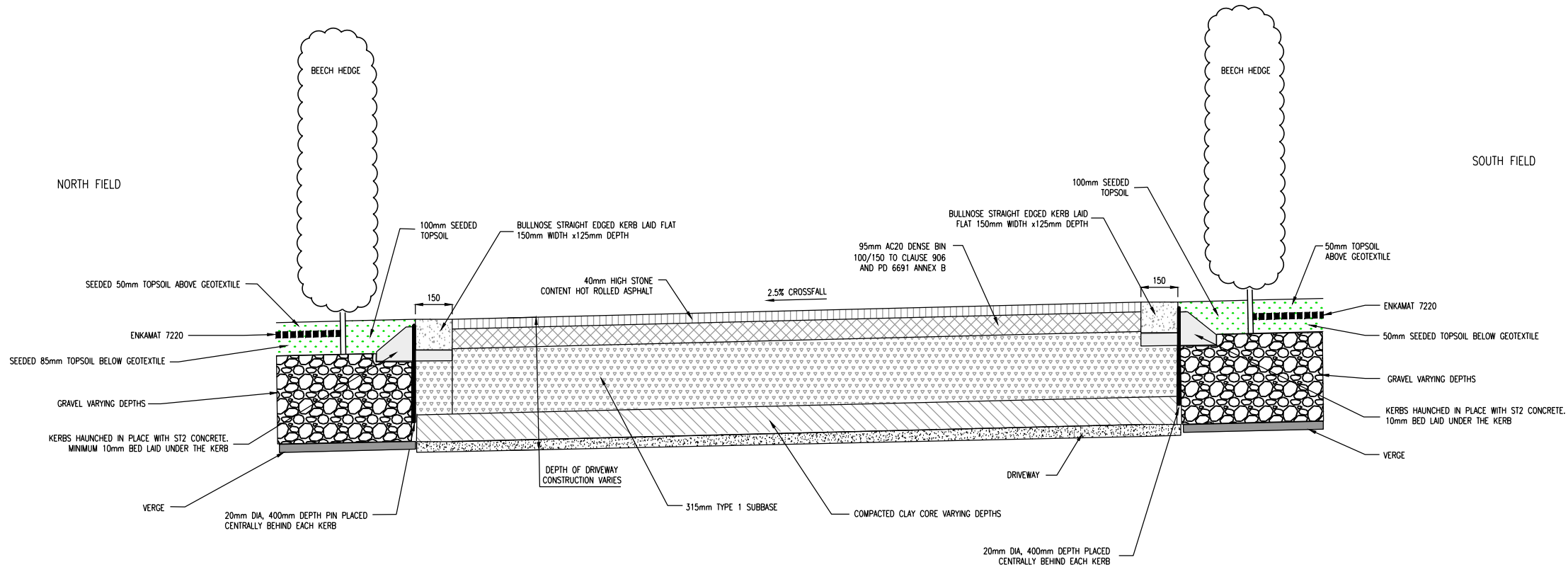

DRIVEWAY CONSTRUCTION OVER HUMPS (Ch 100 to Ch 140)

(NTS)

NOTES

1. ALL DIMENSIONS ARE IN MILLIMETRES UNLESS OTHERWISE STATED.
2. ALL LEVELS ARE IN METRES ABOVE ORDNANCE DATUM.
3. ALL GEOTEXTILES LAID IN ACCORDANCE WITH MANUFACTURERS INSTRUCTIONS.
4. ENKAMAT CUT TO SUIT AROUND TREES/HEDGE TRUNKS. ENKAMAT CUT TO LEAVE A 100mm GAP AROUND THE CIRCUMFERENCE OF THE TRUNK. CUT ENKAMAT NOT BUTTED UP TO EACH ROLL BUT LAPPED BY A MIN OF 300mm.
5. ALL TOPSOIL SOURCED LOCALLY. 50mm LAYER BELOW GEOTEXTILE SEEDED WITH BRITISH SEED HOUSES AMENITY MIX A18; SOWING RATE 35g/m².
6. DRIVEWAY CONSTRUCTION IN ACCORDANCE WITH SPECIFICATION FOR HIGHWAYS WORKS (S.H.W). DRIVEWAY CONSTRUCTION (SEE DETAIL INSET) PROVIDED ALONG FULL LENGTH OF DRIVEWAY RE-PROFILING SHOWN ON DRAWING 1033064/020/AB/007.
7. WHERE DRIVEWAY IS CONSTRUCTED OVER CLAY FILL (OR OTHER COHESIVE MATERIAL), THE PAVEMENT MAKE UP (40mm SURFACE, 95mm BINDER, 315mm SUBBASE) ACCUMULATES TO A TOTAL DEPTH OF 450mm. THIS IS TO ENSURE A MINIMUM DEPTH OF MATERIAL IS NOT SUSCEPTIBLE TO FROST (BOUND AND UNBOUND).
8. ALL FILL MATERIAL USED FOR THE ROAD CONSTRUCTION PLACED AND COMPACTED IN ACCORDANCE WITH SERIES 600 OF S.H.W. REFER TO TABLE 6/1 FOR MATERIAL CLASSIFICATION AND COMPACTION REQUIREMENTS.
9. REFER TO CIVIL ENGINEERING SPECIFICATION FOR WATER INDUSTRY (CESW) 7th EDITION, SECTION 5 FOR PIPE LAYING DETAILS.
10. EXTENTS OF HEDGE ROOTS IN DRIVEWAY VERGE NOT SHOWN.

Location:	All surfaces to be overlaid with bituminous material. All bituminous surfaces more than 24 hours old, or any bituminous surfaces less than 24 hours of which in the opinion of the Superfacing Engineer require treatment before placing of additional bituminous layers; Where necessary to protect subgrade and sub base from deterioration from ingress of water.
Type of Binder (Clause 920.2):	As described in Section 8.7 of RN 39.
Binder Grade or Classification (Clause 920.2):	Grade S46 Tar is not permitted. Class K1-70 emulsion is preferred for sealing large areas in conditions of high humidity and low temperature. Classes K1-40 and A1-40 are suitable where recommended by the manufacturer.
Rate of Spread (Clause 920.2):	0.4 to 0.6 t/sq.m.
Permitted Additives to Binder (Clause 920.3):	Additives are not required.
Blinding Material (Clause 920.6):	Blinding material shall be used in any circumstance where traffic uses the surface before the bituminous spray is overlaid, to avoid pickling up.
Other Special Requirements:	As a tack coat under rolled asphalt or coated macadam the recommendations given in Section 5.5 of BS 594987: 2010 and BS EN 13808:2005 should be used.

TABLE 1 - BOND COATS, TACK COATS AND OTHER BITUMINOUS SPRAYS

REFERENCE DRAWINGS

- 1033064/020/AB/007 - TOMNAGASKE DRIVEWAY - AS BUILT GENERAL ARRANGEMENT
- 1033064/020/AB/008 - TOMNAGASKE DRIVEWAY - AS BUILT TYPICAL CROSS SECTIONS
- 1033064/020/AB/009 - TOMNAGASKE DRIVEWAY - AS BUILT SERVICES
- 1033064/020/AB/010 - TOMNAGASKE DRIVEWAY - AS BUILT GEOTEXTILE CONSTRUCTION DETAILS
- 1033064/020/AB/011 - TOMNAGASKE DRIVEWAY - AS BUILT FLOOD EMBANKMENT TYPICAL CROSS SECTION
- 1033064/020/AB/012 - TOMNAGASKE DRIVEWAY - AS BUILT WALL & GATE POSTS
- 1033064/020/AB/013 - TOMNAGASKE DRIVEWAY - AS BUILT PAVEMENT CONSTRUCTION
- 1033064/020/AB/014 - TOMNAGASKE DRIVEWAY - AS BUILT SURFACING
- 1033064/020/AB/015 - TOMNAGASKE DRIVEWAY - AS BUILT CROSS SECTIONS

At original drawing size (A1) this line measures 100mm

	SURFACE COURSE		TOPSOIL (LOCALLY SOURCED)
	BINDER COURSE		COMPACTED CLAY CORE
	RC2 REGULATING COURSE SHW CL 907		ENKAMAT 7220
	TYPE 1 SUB BASE		GRAVEL
	KERB		VERGE
			PREVIOUS DRIVEWAY

Version	Amendment	Checked Date	Approved Date
Z	AS-BUILT - FINAL	A.BURKE 29.05.14	S.GILLIAND 30.05.14
B	AS-BUILT	S.BURRIDGE 30.10.13	S.GILLIAND 30.10.13
A	AS BUILT	J.MCCAFFERY 21.06.13	J.MCDONALD 21.06.13

Client	PERTH & KINROSS COUNCIL
Project	DALGINROSS (WATER OF RUCHILL) FLOOD PROTECTION WORKS
Drawing Title	TOMNAGASKE DRIVEWAY - AS BUILT PAVEMENT CONSTRUCTION DETAILS

		Scales (at A1 size)	
GLASGOW		AS SHOWN	
01698 802 850		Purpose of Issue	
		AS BUILT	
Office	Tel No	Drawing No	Version
GLASGOW	01698 802 850	1033064/020/AB/013	Z

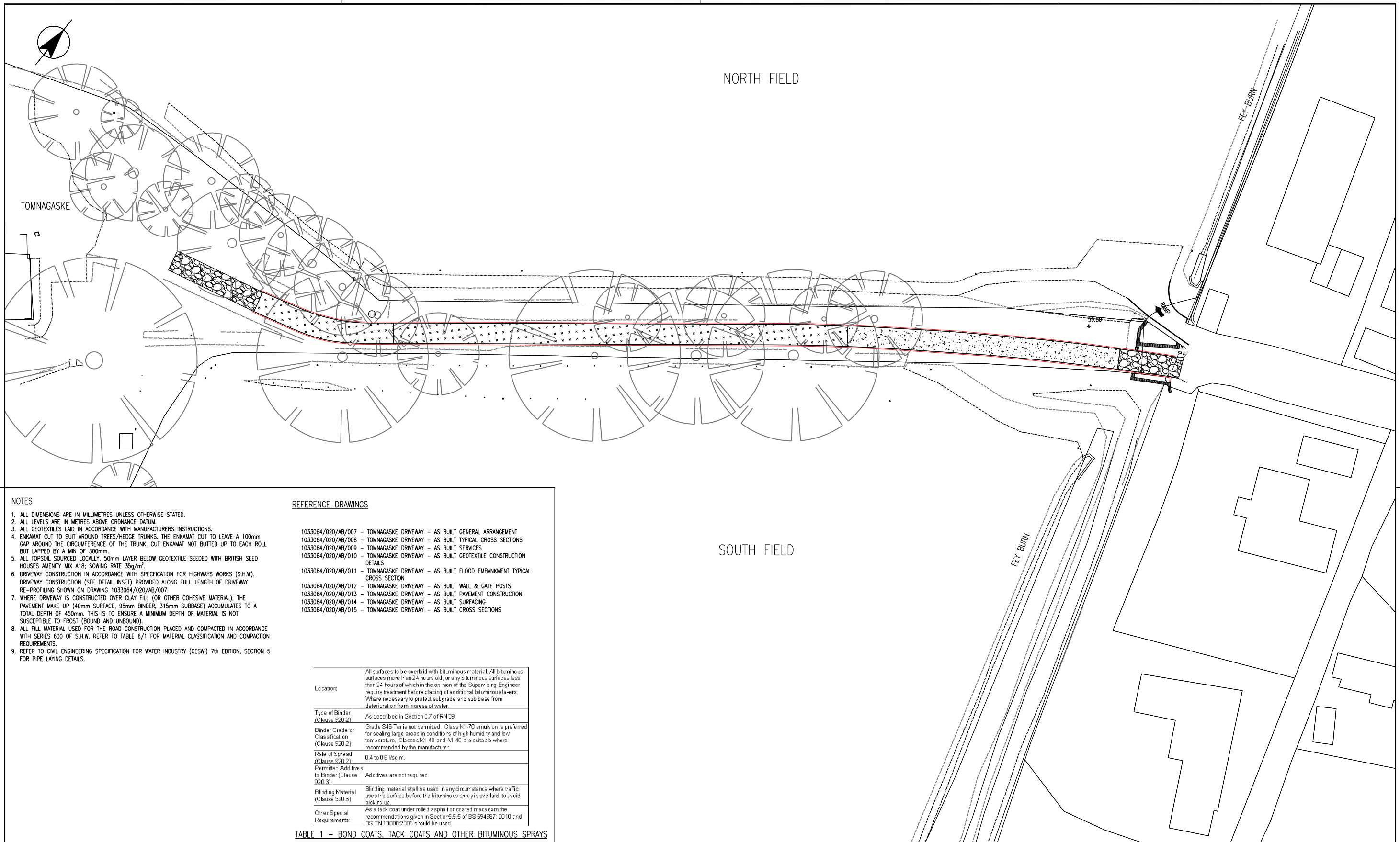

NOTES

1. ALL DIMENSIONS ARE IN MILLIMETRES UNLESS OTHERWISE STATED.
2. ALL LEVELS ARE IN METRES ABOVE ORDNANCE DATUM.
3. ALL GEOTEXTILES LAID IN ACCORDANCE WITH MANUFACTURERS INSTRUCTIONS.
4. ENKAMAT CUT TO SUIT AROUND TREES/HEDGE TRUNKS. THE ENKAMAT CUT TO LEAVE A 100mm GAP AROUND THE CIRCUMFERENCE OF THE TRUNK. CUT ENKAMAT NOT BUTTED UP TO EACH ROLL BUT LAPPED BY A MIN OF 300mm.
5. ALL TOPSOIL SOURCED LOCALLY. 50mm LAYER BELOW GEOTEXTILE SEEDED WITH BRITISH SEED HOUSES AMENITY MIX A18; SOWING RATE 35g/m².
6. DRIVEWAY CONSTRUCTION IN ACCORDANCE WITH SPECIFICATION FOR HIGHWAYS WORKS (S.H.W). DRIVEWAY CONSTRUCTION (SEE DETAIL INSET) PROVIDED ALONG FULL LENGTH OF DRIVEWAY RE-PROFILING SHOWN ON DRAWING 1033064/020/AB/007.
7. WHERE DRIVEWAY IS CONSTRUCTED OVER CLAY FILL (OR OTHER COHESIVE MATERIAL), THE PAVEMENT MAKE UP (40mm SURFACE, 95mm BINDER, 315mm SUBBASE) ACCUMULATES TO A TOTAL DEPTH OF 450mm. THIS IS TO ENSURE A MINIMUM DEPTH OF MATERIAL IS NOT SUSCEPTIBLE TO FROST (BOUND AND UNBOUND).
8. ALL FILL MATERIAL USED FOR THE ROAD CONSTRUCTION PLACED AND COMPACTED IN ACCORDANCE WITH SERIES 600 OF S.H.W. REFER TO TABLE 6/1 FOR MATERIAL CLASSIFICATION AND COMPACTION REQUIREMENTS.
9. REFER TO CIVIL ENGINEERING SPECIFICATION FOR WATER INDUSTRY (CESWI) 7th EDITION, SECTION 5 FOR PIPE LAYING DETAILS.

REFERENCE DRAWINGS

- 1033064/020/AB/007 - TOMNAGASKE DRIVEWAY - AS BUILT GENERAL ARRANGEMENT
- 1033064/020/AB/008 - TOMNAGASKE DRIVEWAY - AS BUILT TYPICAL CROSS SECTIONS
- 1033064/020/AB/009 - TOMNAGASKE DRIVEWAY - AS BUILT SERVICES
- 1033064/020/AB/010 - TOMNAGASKE DRIVEWAY - AS BUILT GEOTEXTILE CONSTRUCTION DETAILS
- 1033064/020/AB/011 - TOMNAGASKE DRIVEWAY - AS BUILT FLOOD EMBANKMENT TYPICAL CROSS SECTION
- 1033064/020/AB/012 - TOMNAGASKE DRIVEWAY - AS BUILT WALL & GATE POSTS
- 1033064/020/AB/013 - TOMNAGASKE DRIVEWAY - AS BUILT PAVEMENT CONSTRUCTION
- 1033064/020/AB/014 - TOMNAGASKE DRIVEWAY - AS BUILT SURFACING
- 1033064/020/AB/015 - TOMNAGASKE DRIVEWAY - AS BUILT CROSS SECTIONS

Location:	All surfaces to be overlaid with bituminous material. All bituminous surfaces more than 24 hours old, or any bituminous surfaces less than 24 hours of which in the opinion of the Supervising Engineer require treatment before placing of additional bituminous layers. Where necessary to protect subgrade and sub base from deterioration from ingress of water.
Type of Binder (Clause 920.2):	As described in Section 8.7 of RN 39.
Binder Grade or Classification (Clause 920.2):	Grade S46 Tar is not permitted. Class K1-70 emulsion is preferred for sealing large areas in conditions of high humidity and low temperature. Classes K1-40 and A1-40 are suitable where recommended by the manufacturer.
Rate of Spread (Clause 920.2):	0.4 to 0.6 kg/m ² .
Permitted Additives to Binder (Clause 920.3):	Additives are not required.
Blinding Material (Clause 920.6):	Blinding material shall be used in any circumstance where traffic uses the surface before the bituminous spray is overlaid, to avoid picking up.
Other Special Requirements:	As a tack coat under rolled asphalt or coated macadam the recommendations given in Section 5.5 of BS 594:87, 2010 and BS EN 13000:2005 should be used.

TABLE 1 - BOND COATS, TACK COATS AND OTHER BITUMINOUS SPRAYS

Reproduced by permission of Ordnance Survey on behalf of Her Majesty's Stationery Office. (c) Crown copyright and database right 2014. All rights reserved. 100016971.

At original drawing size (A1) this line measures 100mm

PLAN
(Scale 1:250)

SCALE 1:250
5m 0m 20m

LEGEND

	OVERLAY (in to driveway) Varying Depth HIGH STONE CONTENT ASPHALT Varying Depth AC20 DENSE BIN 100 / 150 SHW CI 906 and PD 6691 ANNEX B		OVERLAY (Driveway build up at Road Hump) 40mm HIGH STONE CONTENT ASPHALT 95mm AC20 DENSE BIN 100 / 150 SHW CI 906 and PD 6691 ANNEX B 315mm SB1 TYPE 1 GRANULAR SUB BASE MATERIAL Varying Depth COMPACTED CLAY CORE
	OVERLAY 40mm HIGH STONE CONTENT ASPHALT 95mm AC20 DENSE BIN 100 / 150 SHW CI 906 and PD 6691 ANNEX B Varying Depth RC REGULATING COURSE		BULLNOSE STRAIGHT EDGED KERB LAID FLAT 150mm WIDTH x 125mm DEPTH

Z	AS-BUILT - FINAL	A.BURKE	S OLLILAND	P.SWIFT
B	AS-BUILT	S.BURRIDGE	S OLLILAND	P.SWIFT
A	AS BUILT	J.MCCAFFERY	J.MCDONALD	R.LANG
Version	Amendment	Drawn Date	Checked Date	Approved Date

Client	PERTH & KINROSS COUNCIL
Project	DALGINROSS (WATER OF RUCHILL) FLOOD PROTECTION WORKS
Drawing Title	TOMNAGASKE DRIVEWAY - AS BUILT SURFACING

		Scales (at A1 size)	
		AS SHOWN	
		Purpose of Issue	
		AS BUILT	
Office	Tel No	Drawing No	Version
GLASGOW	01698 802 850	1033064/020/AB/014	Z

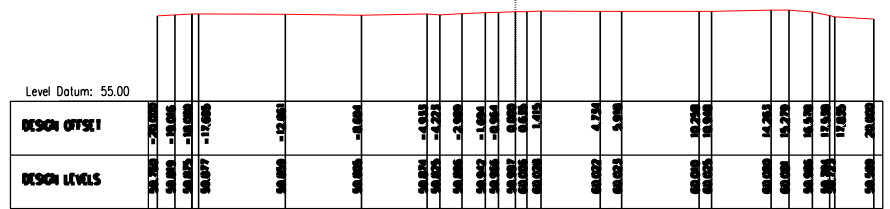

Chainage = 0.000

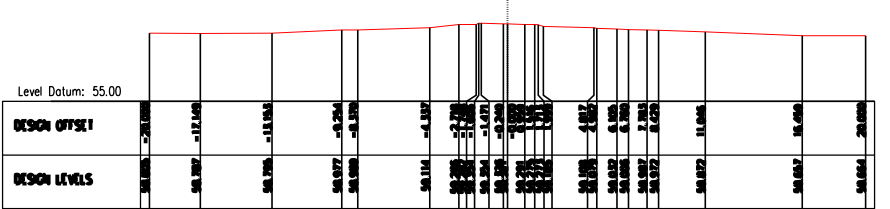

Chainage = 60.000

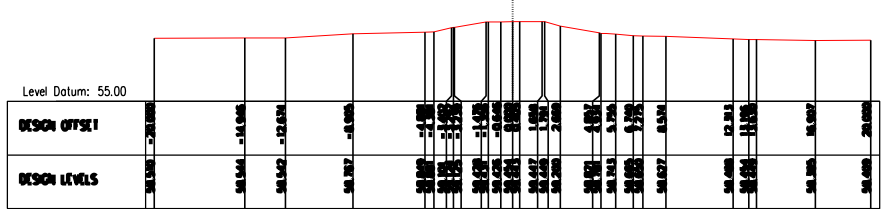

Chainage = 110.000

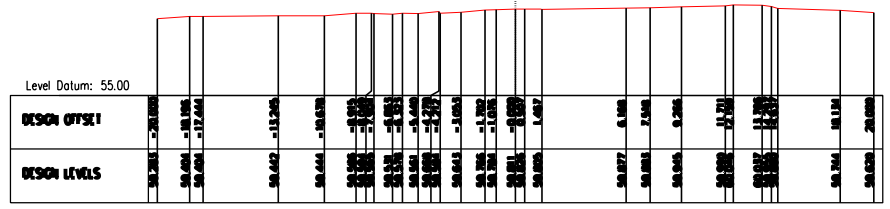

Chainage = 10.000

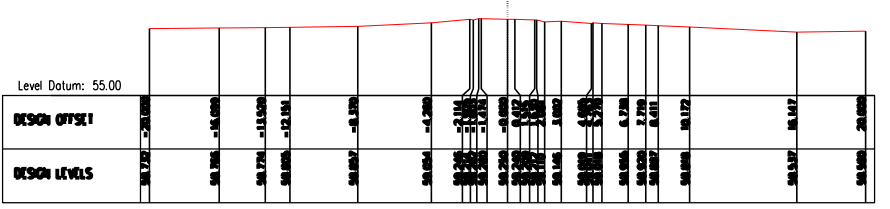

Chainage = 70.000

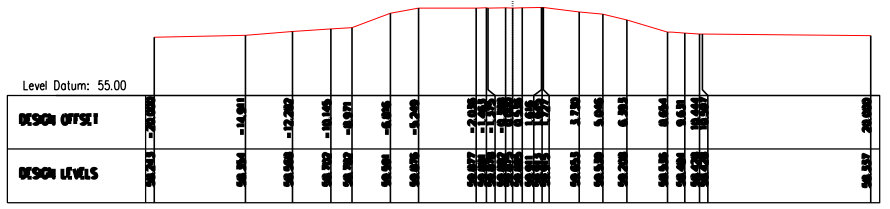

Chainage = 120.000



Chainage = 20.000

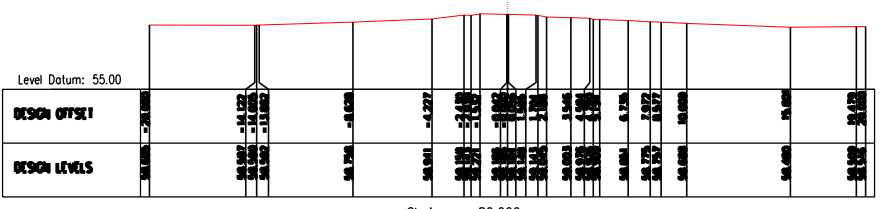

Chainage = 80.000

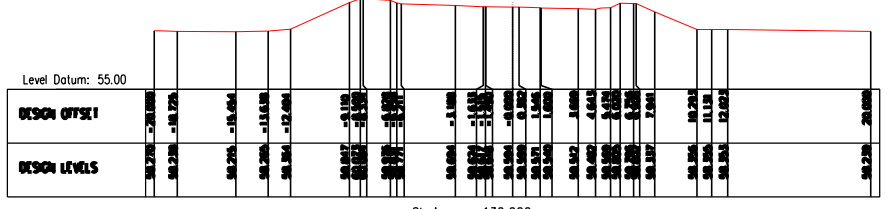

Chainage = 130.000

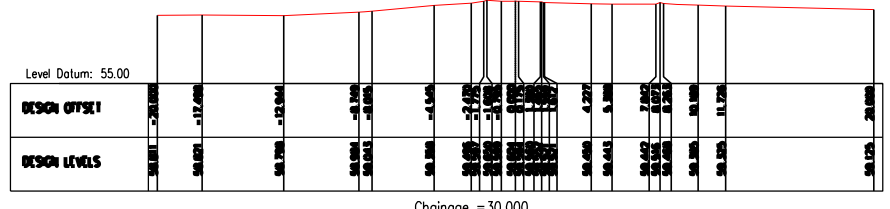

Chainage = 30.000

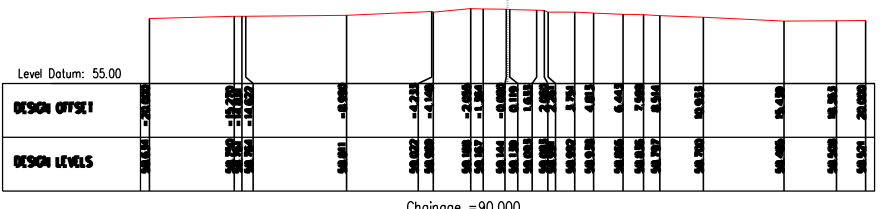

Chainage = 90.000

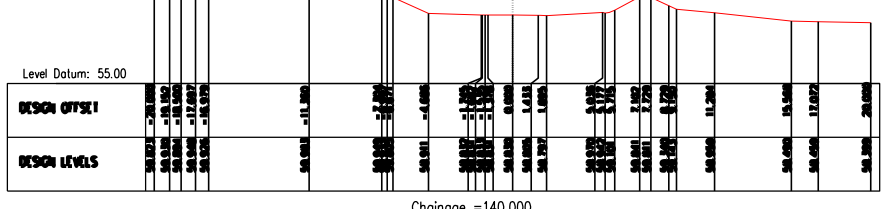

Chainage = 140.000

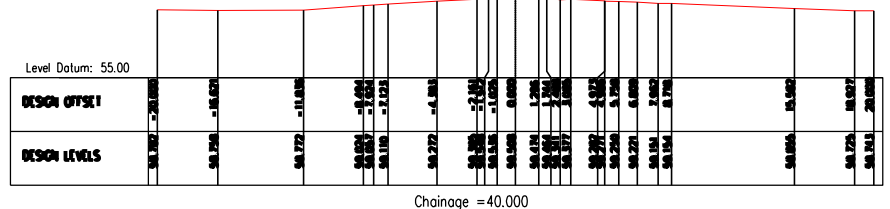

Chainage = 40.000

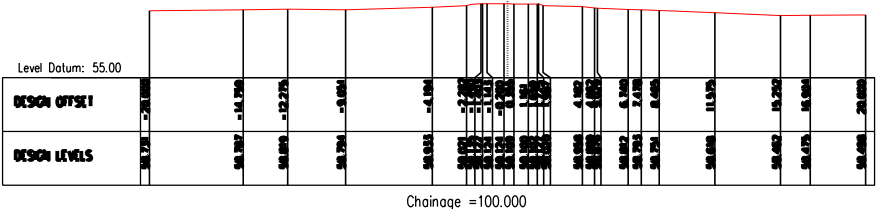

Chainage = 100.000

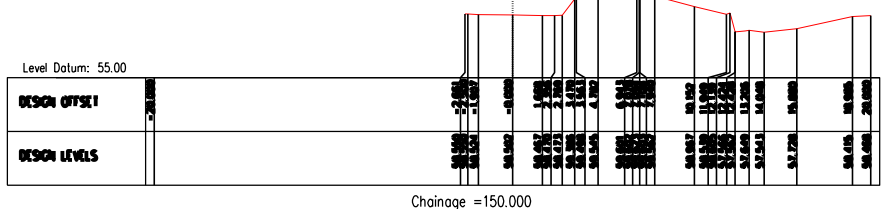

Chainage = 150.000

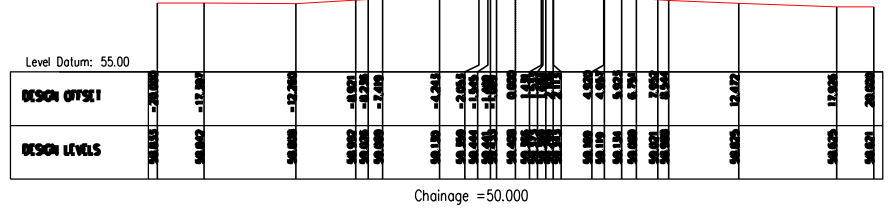

Chainage = 50.000

CROSS SECTION CHAINAGE	EASTING (APPROX)	NORTHING (APPROX)
CH 00	277242.901	721381.421
CH 10	277252.557	721384.064
CH 20	277262.215	721386.707
CH 30	277271.873	721391.012
CH 40	277279.037	721397.241
CH 50	277286.857	721403.473
CH 60	277294.682	721409.700
CH 70	277302.501	721415.934

CROSS SECTION CHAINAGE	EASTING (APPROX)	NORTHING (APPROX)
CH 80	277310.314	721422.176
CH 90	277318.137	721428.405
CH 100	277326.082	721434.481
CH 110	277334.175	721440.360
CH 120	277342.393	721446.061
CH 130	277350.752	721451.553
CH 140	277359.242	721456.836
CH 150	277367.899	721461.860

SCALE - HORIZ 1:100 VERT 1:100

- NOTES
- ALL DIMENSIONS ARE IN MILLIMETRES UNLESS OTHERWISE STATED.
 - ALL LEVELS ARE IN METRES ABOVE ORDNANCE DATUM.
 - DRIVEWAY WIDTH VARIES.
 - FOR CHAINAGE LOCATIONS SEE DRAWING No.1033064/020/AB/007.

- REFERENCE DRAWINGS
- 1033064/020/AB/007 - TOMNAGASKE DRIVEWAY - AS BUILT GENERAL ARRANGEMENT
 - 1033064/020/AB/008 - TOMNAGASKE DRIVEWAY - AS BUILT TYPICAL CROSS SECTIONS
 - 1033064/020/AB/009 - TOMNAGASKE DRIVEWAY - AS BUILT SERVICES
 - 1033064/020/AB/010 - TOMNAGASKE DRIVEWAY - AS BUILT GEOTEXTILE CONSTRUCTION DETAILS
 - 1033064/020/AB/011 - TOMNAGASKE DRIVEWAY - AS BUILT FLOOD EMBANKMENT TYPICAL CROSS SECTION
 - 1033064/020/AB/012 - TOMNAGASKE DRIVEWAY - AS BUILT WALL & GATE POSTS
 - 1033064/020/AB/013 - TOMNAGASKE DRIVEWAY - AS BUILT PAVEMENT CONSTRUCTION
 - 1033064/020/AB/014 - TOMNAGASKE DRIVEWAY - AS BUILT SURFACING
 - 1033064/020/AB/015 - TOMNAGASKE DRIVEWAY - AS BUILT CROSS SECTIONS

At original drawing size (A1) this line measures 100mm

LEGEND GROUND LEVEL	Z AS-BUILT - FINAL B AS-BUILT A AS BUILT	A.BURKE 29.05.14 S.BURRIDGE 30.10.13 J.MCCAFFERTY 21.06.13	S OLLIAND 30.05.14 S OLLIAND 30.10.13 J.MACDONALD 21.06.13	P.SWIFT 30.05.14 P.SWIFT 30.10.13 R.LJANG 21.06.13	 Client: PERTH & KINROSS COUNCIL Project: DALGINROSS (WATER OF RUCHILL) FLOOD PROTECTION WORKS Drawing Title: TOMNAGASKE DRIVEWAY - AS BUILT CROSS SECTIONS	 Office: GLASGOW Tel No: 01698 802 850	Scales (at A1 size) 1:100 Purpose of Issue AS BUILT	Drawing No 1033064/020/AB/015	Version Z

APPENDIX E – Camp Road Flood Protection Scheme