

APPENDIX N - Key Constraints Map from Site Visit

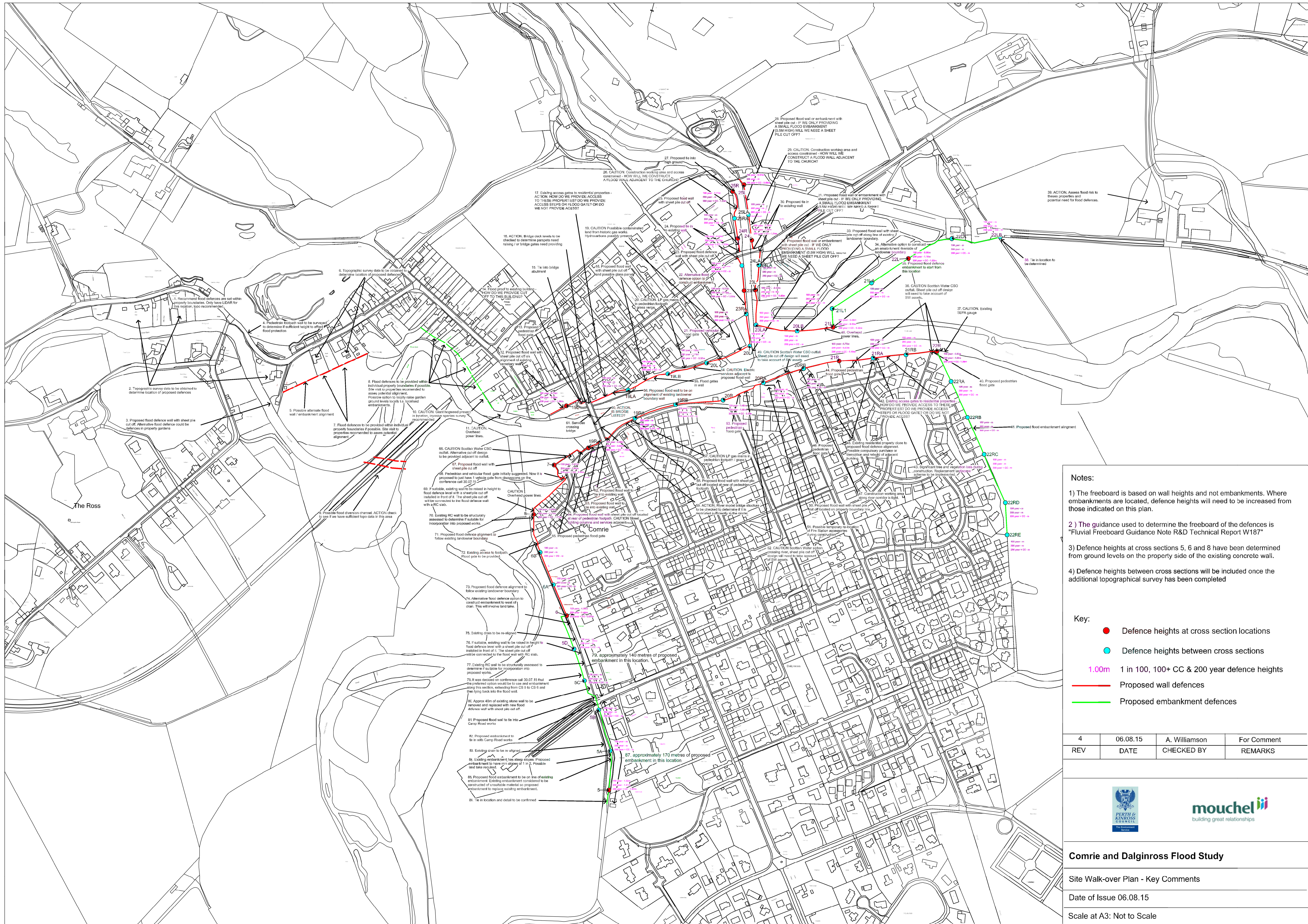

- Notes:**
- 1) The freeboard is based on wall heights and not embankments. Where embankments are located, defence heights will need to be increased from those indicated on this plan.
 - 2) The guidance used to determine the freeboards is "Fluvial Freeboard Guidance Note R&D Technical Report W187"
 - 3) Defence heights at cross sections 5, 6 and 8 have been determined from ground levels on the property side of the existing concrete wall.
 - 4) Defence heights between cross sections will be included once the additional topographical survey has been completed

- Key:**
- Defence heights at cross section locations
 - Defence heights between cross sections
 - 1.00m 1 in 100, 100+ CC & 200 year defence heights
 - Proposed wall defences
 - Proposed embankment defences

REV	DATE	CHECKED BY	REMARKS
4	06.08.15	A. Williamson	For Comment

